

SECTION

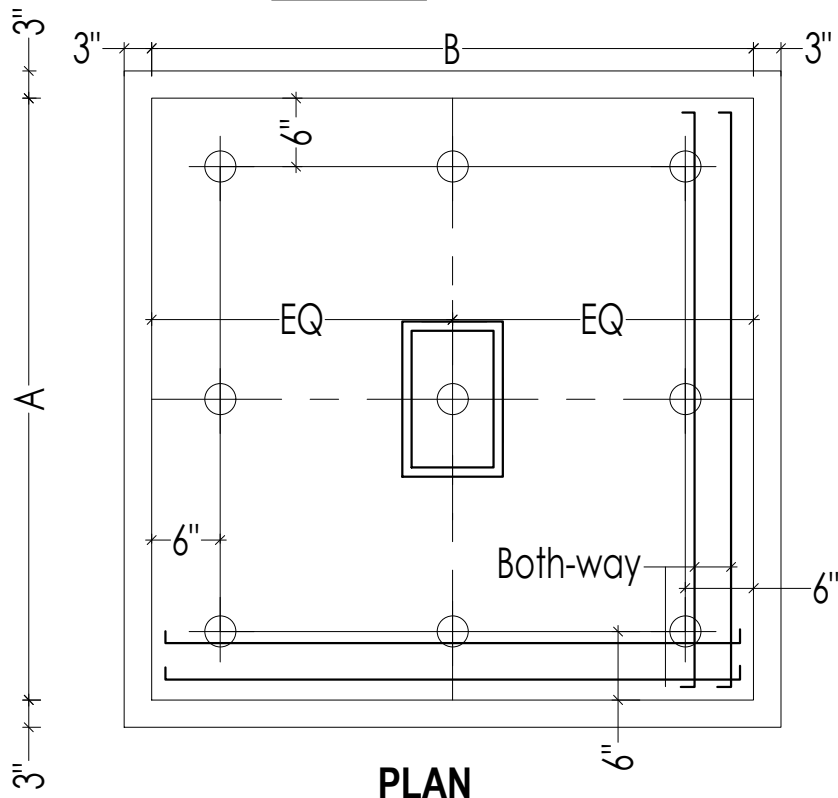

PLAN

SHEET ROCK FOOTING DETAIL'S

FOR COLUMN

General Notes :-

1. Use M25 (1:1:2) grade for columns & M20 (1:1.5:3) for footings, slab & Beams
2. Use FE 500 grade tor steel.
3. Provide clear cover of 2" for footings & 1.5" for columns.
4. S.B.C of the Soil is taken as 350kn/m2.
5. Footings are design for Ground & 1st floor.
6. Provide clear cover of 1" for beams
7. All loose pockets should be filled by p.c.c (1:2:4).
8. Rock foundation should have anchor rods in the rock .

DESCRIPTION		DATE
Client	MODI PROPERTIES & INVESTMENTS PVT.LTD	
Project	MIRYALGUDA - (CLUB HOUSE)	
STRUCTURAL CONSULTANT	 KULKARNI CONSULTANT'S STRUCTURAL ENGINEERS, ARCHITECTS & PROJECT CONSULTANT'S #216, KUBERA TOWER'S, NARAYAN GUDA, HYDERABAD. CONTACT NO'S:- 04023223891, 09246343724, 09246343720.	
DATE	22-9-2017	MIRYALGUDA (CLUB HOUSE)
DEALT BY	PAWAN	TITLE: SHEET ROCK FOOTING DETAILS
DESIGN BY	SANTOSH	
CHECKED & APPROVED:	KULKARNI	DWG. NO. KC/SOV9/SD/
		REV. No. 0