

SCHEDULE OF SLABS				
SLAB MARK	THICKNESS	TYPE	REINFORCEMENT STEEL AT	
			SHORT SPAN	LONG SPAN
S1	4 1/2" THK	+	80 @ 8" C/C	80 @ 8" C/C
S2	4 1/2" THK	—	80 @ 8" C/C	80 @ 8" C/C
S3	4 1/2" THK	+	80 @ 7" C/C	80 @ 7" C/C
S4	4 1/2" THK	—	100 @ 5" C/C	80 @ 8" C/C
S5	4 1/2" THK	+	80 @ 5" C/C	80 @ 7" C/C

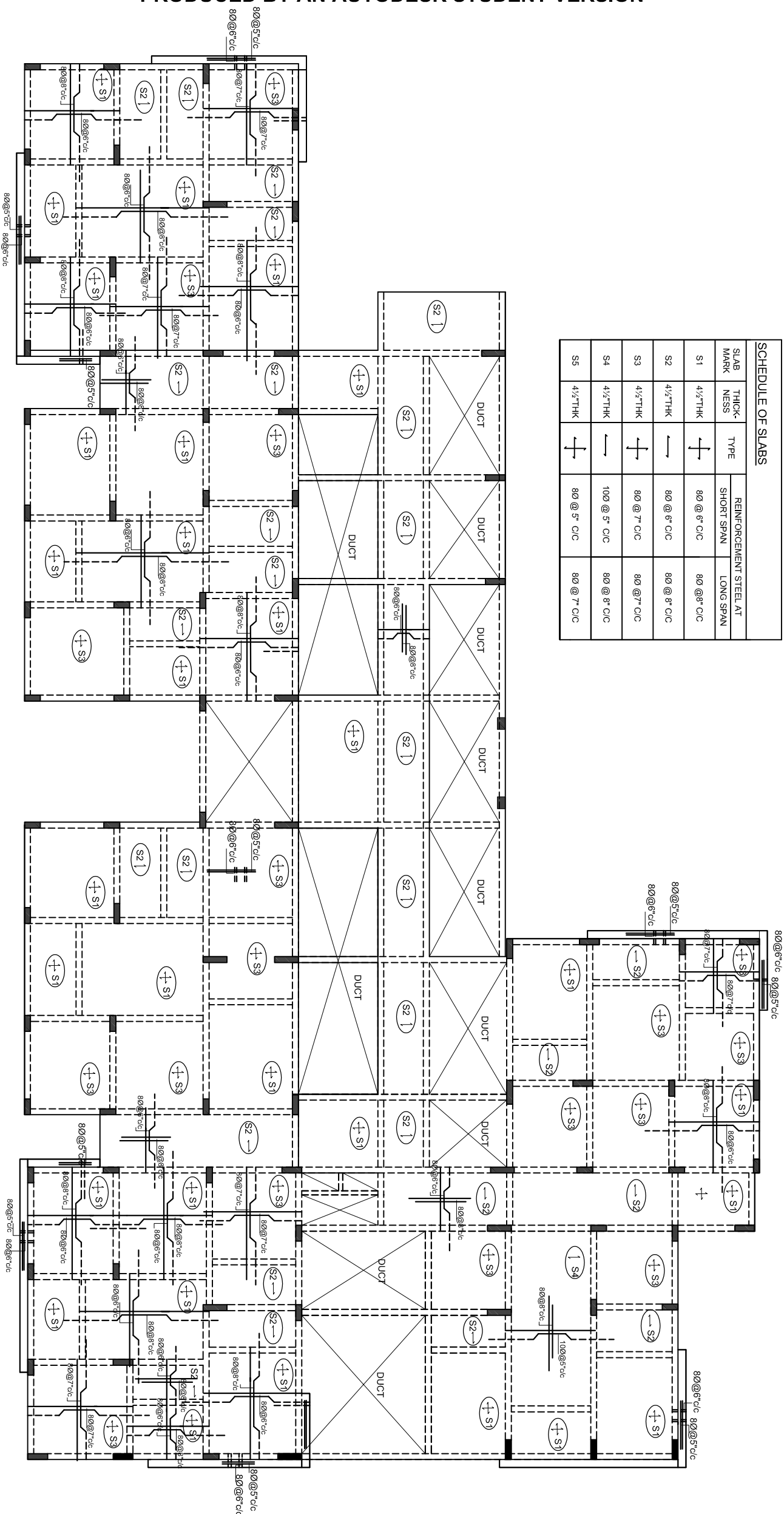

NOTE:

- DO NOT SCALE THIS DRAWING FOLLOW FIGURED DIMENSIONS
- ALL THE DIMENSIONS ARE IN INCHES & FEET.
- REFER ARCHITECT DRAWING FOR CENTER LINE DIMENSIONS
- THIS BUILDING IS DESIGNED FOR TWO CELLAR +GROUND+HINE FLOORS ONLY.
- S.B.C. OF SOIL IS TAKEN 400.KN/SQM AS PER SOIL REPORT
- USE M25 (1:1:2) GRADE CONCRETE FOR COLUMNS & M20 (1:1.5:3) FOR BEAMS & SLAB
- USE FE 500 GRADE TOR STEEL.
- PROVIDE CLEAR COVER OF 1.5" FOR COLUMNS , 1"FOR BEAMS & 3/4" FOR SLAB
- LAP LENGTH INCLUDING ANCHORAGE VALUE OF HOOKS FOR BARS IN FLEXURAL TENSION SHALL BE L4 OR 30Ø WHICHEVER IS GREATER. THE STRAIGHT LENGTH OF THE LAP SHALL NOT BE LESS THAN 15Ø OR 200mm. WHEN BARS OF TWO DIFFERENT DIAMETERS ARE TO BE SPLICED, THE LAP LENGTH SHALL BE CALCULATED ON THE BASIS OF DIAMETER OF THE SMALLER BAR.
- LAP / DEVELOPMENT LENGTH FOR MAIN REINFORCEMENT BARS FOR DIFFERENT GRADES OF CONCRETE MIX SHALL BE AS FOLLOWS:
STEEL GRADE M20 M25 M30 M35
Fe 415 47 d 41 d 38 d 34 d
Fe 500 57 d 49 d 46 d 40 d
- WHERE d IS THE DIAMETER OF THE BAR.
- ANY LOOSE OR PROTRUDING BUILDERS SHALL BE REMOVED BEFORE
- LAYING FOUNDATION CONCRETE AND SHALL BE FILLED WITH P.C.C.
- CONCRETE SHALL BE VIBRATED FOR OBTAINING OPTIMUM DENSITY.
- THE DIFFERENCE IN LEVELS OF DEPTH OF ADJACENT FOOTING SHALL NOT BE GREATER THAN HALF THE CLEAR DISTANCE BETWEEN THEM.
- STIRRUPS SHOULD HAVE STANDARD HOOK AS PER SP-34.
- THE PROVISIONS MADE IN IS: 456-2000 AND SP-34 AND OTHER RELEVANT CODES SHOULD BE STRICTLY ADHERED DURING EXECUTION .
- IF ANY VARIATION IN SOIL STRATA FOUND DURING THE EXECUTION OF THE FOUNDATION SOLS, WHEN COMPARED WITH THE CONSIDERED STRATA IT SHOULD BROUGHT TO THE NOTICE OF ENGINEER IN CHARGE AND CONSULTANTS FOR REVISING FOUNDATIONS.
- S.B.C. OF SOIL IS TAKEN 400.KN/SQM AS PER SOIL REPORT NO. GT/0260/2009-10/VISIT ON 28-02-2014
- BORE POINTS /REFER BORE HOLES (5 & 6)

DESCRIPTION	DATE

Client MODI PROPERTIES & INVESTMENTS PVT.LTD

Project KULKARNI CONSULTANTS

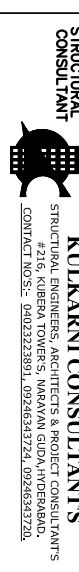

DATE	9-12-2016	BLOCK - (E)
DRAWN BY	PAWANI	TITLE: 12th SLAB PROJECTIONS
DESIGN	SRIKANTH	SLAB DETAILS
CHECKED		DWG. NO. KC/MBC/SD/E/17A
APPROVED	KILKARNI	REV. NO. 0