

DRAWING ROOM  
12' 3" x 11' 7"

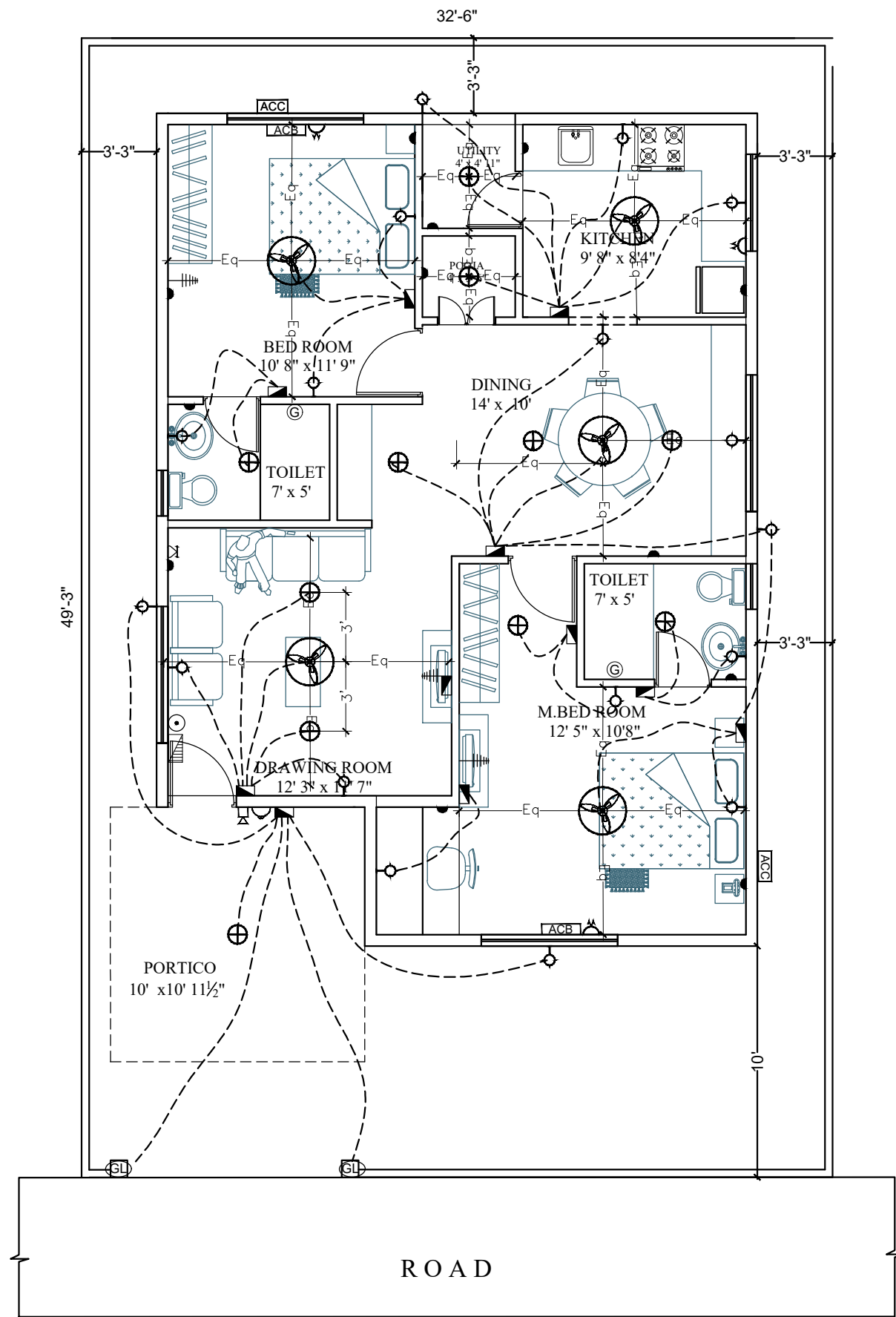

GROUND FLOOR PLAN

LEGEND:-

S.NO	ITEM	SYMBOL
1.	Distribution Board & Change over	
2.	Switch board	
3.	Wall point/Bracket light	
4.	5 amps plug point	
5.	Ceiling fan	
6.	Geyser point - 15A	
7.	Exhaust fan	
8.	15 amps plug point	
9.	Television point	
10.	Telephone point	
11.	Calling Bell	
12.	Bell Push	
13.	Ceiling light	
14.	Video Phone	
15.	AC Compressor	
16.	AC Blower	
17.	Switch board with 5A socket	
18.	Gate Lights	

Note :- Switch boards next to bed side must be centered @ 3'6" center of bed.

Description	Direction	Owners & Developers :	Date :	22.04.17	Promoted by
ELECTRICAL PLAN TYPE - A (single floor)		Modi Properties Pvt Ltd.	Prepared By :	Rahul	Modi Properties Pvt. Ltd. Phone:+91-40-66335551
		Project Name & Phase :	Approved By :	Soham Modi	
		Bloomdale - Shamirpet, Hyderabad	Scale :	N.T.S	