

- NOTES**
1. ALL THE DIMENSIONS ARE IN FPS SYSTEM.
  2. ONLY FIGURED DIMENSIONS SHALL BE FOLLOWED, DO NOT SCALE THE DRAWING.
  3. THIS SHEET SUPERSEDES ALL PREVIOUSLY REVISED ARCHITECTURAL DRAWING OF SAME NUMBERS.
  4. ALL LARGE SCALE DRAWINGS SHALL SUPERSEDE THE SMALL SCALE ONES.
  5. ANY DISCREPANCY IN THE DRAWINGS SHALL BE BROUGHT TO THE NOTICE OF THE CONSULTANTS, BEFORE EXECUTION OF WORK.

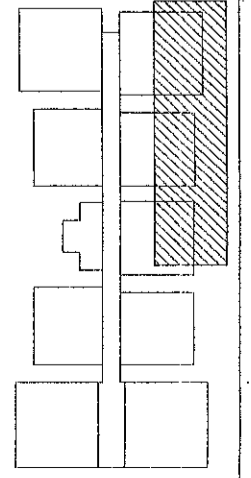

**APPROVED FOR CONSTRUCTION**

**GOOD FOR CONSTRUCTION**

DATE: 26/07/13

SCALE: N.T.S.

**Architects & Engineers:**  
**KULKARNI CONSULTANTS**  
 ARCHITECTS, ENGINEERS & PROJECT CONSULTANTS  
 54-157/294, SOHANI INDUSTRIAL ESTATE,  
 2ND FLOOR, MIDC, KOTDAWARA, MUMBAI 400 034, INDIA.  
 CONTACT NOS: 9822232811, 9822347274, 9822347278.  
 Email: info@modiproperties.com

**Developers:**  
**MODI PROPERTIES & INVESTMENTS**  
 54-157/294, SOHANI INDUSTRIAL ESTATE,  
 2ND FLOOR, MIDC, KOTDAWARA, MUMBAI 400 034, INDIA.  
 CONTACT NOS: 9822232811, 9822347274, 9822347278.  
 Email: info@modiproperties.com

**Owner's & Developers:**  
**VISTA HOMES**

**TITLE:**  
**EAST SIDE ELEVATION**  
**(PART-02 / 02)**

DWG. NO: KCMHAD/BN/21

REV. NO. 01

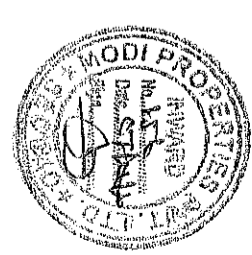

**APPROVED FOR CONSTRUCTION**

DATE: 26/07/13

