

- NOTES**
1. ALL THE DIMENSIONS ARE IN FPS SYSTEM.
  2. ONLY FIGURED DIMENSIONS SHALL BE FOLLOWED, DO NOT SCALE THE DRAWING.
  3. THIS SHEET SUPERSEDES ALL PREVIOUSLY REVISED ARCHITECTURAL DRAWING OF SAME NUMBERS
  4. ALL LARGE SCALE DRAWINGS SHALL SUPERSEDE THE SMALL SCALE ONES.
  5. ANY DISCREPANCY IN THE DRAWINGS SHALL BE BROUGHT TO THE NOTICE OF THE CONSULTANTS, BEFORE EXECUTION OF WORK.

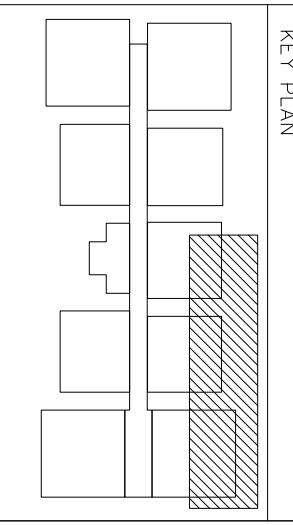

REV. NO.	DESCRIPTION	DATE
01	FLOOR HEIGHTS ARE CHANGED	24-07-13

**GOOD FOR CONSTRUCTION**



**Owners & Developers:**  
**MOJI PROPERTIES & INVESTMENTS**  
 501/17/2&A, S&A, 1st Floor,  
 M.G. Road, Secunderabad-500003.  
 Phone:6335511(direct) Fax:440-27544058  
 Email: info@mojiproperties.com

**Architects & Engineers:**  
**KULKARNI CONSULTANTS**  
 STRUCTURAL ENGINEERS, ARCHITECTS & PROJECT CONSULTANTS  
 #216, KUBERA TOWNS, NARAYAN GUDA, HYDRABAD.  
 CONTACT NOS: 840222891, 09246343724, 09246343726.

SCALE:	NTS	VISTA HOMES
DATE:	26-12-13	EAST SIDE ELEVATION
DRAWN:		[PART-01] / 02]
CHECKED:	KULKARNI	
APPROVED:		
DWG. NO.:	KC/VA/AD/B/F/21	REV. NO.: