

REVISED CENTER LINE PLAN

COLUMN DETAIL'S					FOOTING DETAIL'S				
Type	Mix	Size	Section	Reinforcement	Type	A	B	d1	Reinforcement
C1	M 25	9"X12"		#6No-12Ø #8Ø@8" c/c	F1	4'-0"	4'-0"	12"	#10Ø@8" c/c
					F2	4'-6"	4'-6"	12"	#10Ø@8" c/c
					F3	5'-0"	5'-0"	15"	#10Ø@7" c/c

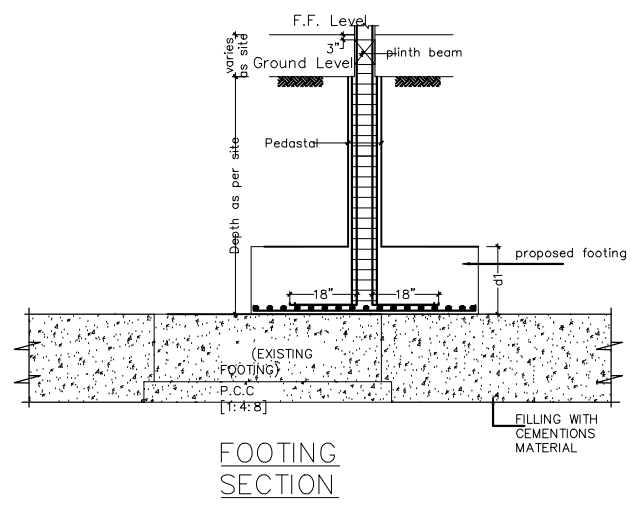

FOOTING SECTION

- General Notes : --
1. Use M25 (1:1:2) grade for columns &
  2. Use M25 (1:1.5:3) grade for footings, slab & Beams
  3. Provide clear cover of 2" for footings &
  4. S.F.C for columns is taken as 350kn/m<sup>2</sup>
  5. Footings are design for Ground & 1st
  6. Provide clear cover of 1" for beams
  7. Read horizontal beams from left to right & vertical from bottom to left
  8. crank +ve bars at L/4 th of span & extend -ve bars to 5th of span
  9. bottom rods at center and top rods at support.
  10. Slab thickness

DESCRIPTION		DATE
GOOD FOR CONSTRUCTIONS		
Client	MODI PROPERTIES & INVESTMENTS PVT.LTD	
Project	NILAGIRI ESTATE AT RAMPALLY, PHASE - II	
STRUCTURAL CONSULTANT	<b>KULKARNI CONSULTANT'S</b> STRUCTURAL ENGINEERS, ARCHITECTS & PROJECT CONSULTANT'S #216, KUBERA TOWER'S, NARAYAN GUDA, HYDERABAD. CONTACT NO'S:- 04023223891, 09246343724, 09246343720.	
DATE	27-4-2017	TYPE - (A2 -SINGLE), WEST FACING (80A)
DEALT BY	PAWAN	TITLE: REVISED COLUMN & FOOTING DETAILS
DESIGN BY		
CHECKED & APPROVED:	KULKARNI	DWG. NO. KC/RP/SD/1
		REV. No. 1