

PLAN SHOWING THE PROPOSED LAYOUT OF RESIDENTIAL PLOTS IN SURVEY Nos. :-  
 31 & 32/p OF MURAHARIPALLY (V)  
 ,YADARAM (G.P) ,MEDCHAL (M), R.R. DIST.  
 SCALE : 1 " = 100 ' - 0 "

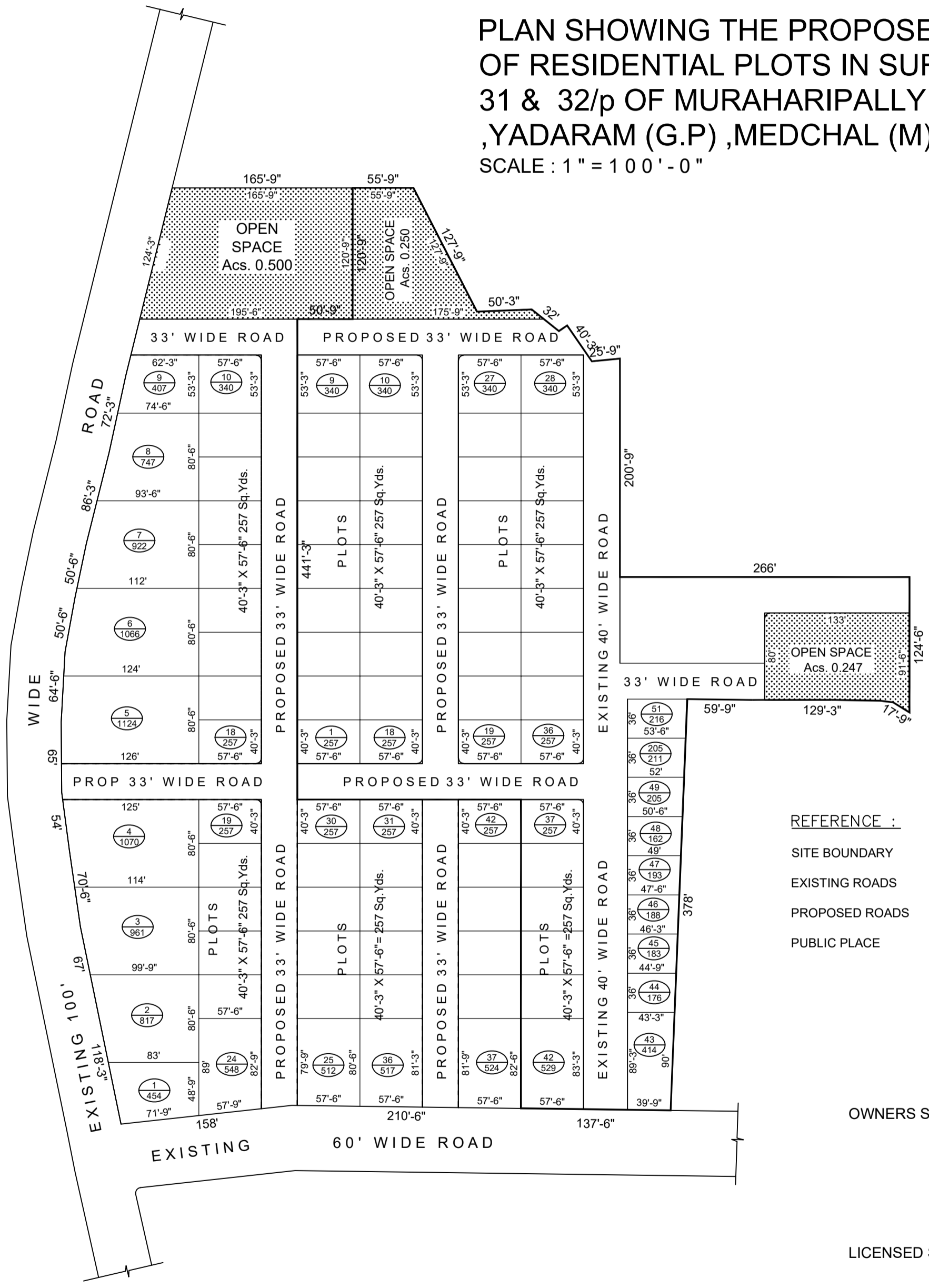

- REFERENCE :
- SITE BOUNDARY
  - EXISTING ROADS
  - PROPOSED ROADS
  - PUBLIC PLACE

OWNERS SIGNATURE

LICENSED SURVEYOR