

ATR on Quality Control Check Report. (Bungalows)

Bungalow No	100	QC report stage	Lab - 2	SI No.	27682
Company		Project		Phase	
Prepared by	F. Athulash	Sign	F. Athulash	Date	2/8/17
Project Manager	Rodhushym	Sign	Rodhushym	Date	2/8/17
Receipt by QC date		Sign		Other	
Receipt at HO date		Sign		Other	
Checked By MD on		MD Sign		For filling	<input type="checkbox"/> Yes <input type="checkbox"/> No

Recommendation that was made by QC:
 Stop further work. Submit ATR on QC report to QC team. Proceed only after recheck by QC.
 Stop further work. Proceed with work after submitting ATR on QC report to QC team.

Notes:

1. Attach a copy of the QC report to this sheet.
2. Circle each correction with a red pen - tick (✓) each circle for work completed and cross (X) each circle where work has not been completed.
3. Give remarks for each case where work has not completed on this sheet.
4. Make 2 copied of the ATR - send one to MD and other to QC.
5. Enclose required photographs - hard copy.

Remarks:

1. Adjusted
2. work completed
3. work completed
4. work completed

Certified that all corrections mentioned in the QC report have been completed. Work can proceed to next stage.

Project in charge	Sign	Date
Radhay	Rodhushym	02/08/17

Quality Control Check Report. Stage: Before Casting Slab (Villas)

Block No	10D	Slab No.	02	SL No.	27682
Company	Milgin estate	Project	Milgin estate	Phase	D
Prepared by	P. Srin Kumar	Sign	P. Srin	Date	18/12
Project Manager	Radheshyam	Sign	Radheshyam	Date	18/12
Previous stage report no.	27513	Report filed and signed by PM?		Yes <input checked="" type="checkbox"/> No <input type="checkbox"/>	
Checked By MD on		MD Sign		For filling	Yes <input type="checkbox"/> No <input type="checkbox"/>

Recommendation:

- Stop further work. Submit ATR on QC report to QC team. Proceed only after recheck by QC.
- Stop further work. Proceed with work after submitting ATR on QC report to QC team.
- Proceed with further work only after making corrections pointed out in the QC report. ATR not required.
- Proceed with further work. ATR not required.

Slab Check.

Note:

- Inspiration should be done before casting of slab at each stage i.e. when the slab is ready for casting.
- Prepare Slab Dimensions Check Plan as follows:
 - a. Show outer dimensions of slab. (Tolerance 2")
 - b. Show length and width of balconies (Tolerance 1")
 - c. Show inner dimensions of ducts. (Tolerance 1")
 - d. Show location of sunken slab.
 - e. Print an A3 size plan.
- Mid landing height is no. of risers x riser height. Measure from SFL to SFL. Check staircase of lower floor that has been casted.
- Circle each correct dimension with green colour. Circle each incorrect dimension with red colour and mention actual dimension next to it.

Slab Dimensions Check Plan enclosed?

	<input checked="" type="checkbox"/> Yes <input type="checkbox"/> No				
Staircase - mid landing 1	Specified ht: 4'-3"	Actual ht: 4'-3 1/2"	Within tolerance of 1/2"?	<input checked="" type="checkbox"/> Yes <input type="checkbox"/> No	
Staircase - mid landing 2	Specified ht: 4'-9"	Actual ht: 4'-9 1/2"	Within tolerance of 1/2"?	<input checked="" type="checkbox"/> Yes <input type="checkbox"/> No	Notations mentioned
Staircase width	Specified wd: 6'-6"	Actual wd: 6'-6"	Within tolerance of 1/2"?	<input checked="" type="checkbox"/> Yes <input type="checkbox"/> No	Certified that all corrections mentioned have been completed.
Staircase slab thickness	Specified: 5"	Actual: 5"	Within tolerance of 1/2"?	<input checked="" type="checkbox"/> Yes <input type="checkbox"/> No	Work can proceed to next stage.

Project in-charge	Sign	Date
Radheshyam	Radheshyam	02/08/17

Quality Control Check Report. Stage: Before Casting Slab (Villas)

Quality of centering, rod bending and concreting.	<input type="checkbox"/> Good <input type="checkbox"/> Avg. <input checked="" type="checkbox"/> Bad
Quality of centering, rod bending and concreting?	<input type="checkbox"/> Yes <input checked="" type="checkbox"/> No
18" extension to beam bottom runners on outer side provided?	<input type="checkbox"/> Good <input checked="" type="checkbox"/> Avg. <input type="checkbox"/> Bad
Quality of Bracing Provided?	<input type="checkbox"/> Good <input checked="" type="checkbox"/> Avg. <input type="checkbox"/> Bad
Alignment of beams on outer side?	<input type="checkbox"/> Good <input checked="" type="checkbox"/> Avg. <input type="checkbox"/> Bad
Shuttering leveling?	<input type="checkbox"/> Good <input checked="" type="checkbox"/> Avg. <input type="checkbox"/> Bad
Column steel overlapping and cranking? (overlapping length should be 45 to 50 D)	<input checked="" type="checkbox"/> Correct <input type="checkbox"/> Needs correction
Remarks:	

Slab Steel check.

Notes:

1. Mark for correct or minor mistake which does not require correction
2. Mark for minor mistake that requires minor correction.
3. Mark for major mistake that requires correction by replacement or re-fixing.
4. Mark for major mistake that cannot be corrected.
5. Columns overlapping length should be 45 to 50 D.

Quality Control Check Report. Stage: Before Casting Slab (Villas)

S No	Item	Quantitative Check (✓ or X)	Qualitative Check (Good / Avg. / Bad)
1.	Steel Check - Beam no of rods	✓	<input type="checkbox"/> Good <input checked="" type="checkbox"/> Avg. <input type="checkbox"/> Bad
2.	Steel Check - Beam size of bars	✓	<input type="checkbox"/> Good <input checked="" type="checkbox"/> Avg. <input type="checkbox"/> Bad
3.	Steel Check - Beams Extra Bars	✓	<input type="checkbox"/> Good <input checked="" type="checkbox"/> Avg. <input type="checkbox"/> Bad
4.	Steel Check - Beams Overlapping & Cranking	<input checked="" type="checkbox"/>	<input type="checkbox"/> Good <input type="checkbox"/> Avg. <input checked="" type="checkbox"/> Bad
5.	Steel Check - Beams Bearing	✓	<input checked="" type="checkbox"/> Good <input type="checkbox"/> Avg. <input type="checkbox"/> Bad
6.	Covering blocks for beams	<input checked="" type="checkbox"/>	<input type="checkbox"/> Good <input type="checkbox"/> Avg. <input checked="" type="checkbox"/> Bad
7.	Depth and width of beams	✓	<input checked="" type="checkbox"/> Good <input type="checkbox"/> Avg. <input type="checkbox"/> Bad
8.	Steel Check - Slab size of bars	✓	<input checked="" type="checkbox"/> Good <input type="checkbox"/> Avg. <input type="checkbox"/> Bad
9.	Steel Check - Slab spacing of bars	✓	<input checked="" type="checkbox"/> Good <input type="checkbox"/> Avg. <input type="checkbox"/> Bad
10.	Steel Check - Slab cranking & chairs	✓	<input type="checkbox"/> Good <input type="checkbox"/> Avg. <input checked="" type="checkbox"/> Bad
11.	Steel Check - Slab Extra Bars	<input checked="" type="checkbox"/>	<input type="checkbox"/> Good <input type="checkbox"/> Avg. <input checked="" type="checkbox"/> Bad
12.	Covering blocks for slab	<input checked="" type="checkbox"/>	<input type="checkbox"/> Good <input type="checkbox"/> Avg. <input checked="" type="checkbox"/> Bad
13.	Steel Check - Column steel overlapping length and cranking	✓	<input checked="" type="checkbox"/> Good <input type="checkbox"/> Avg. <input type="checkbox"/> Bad
14.	Electrical Conducting	✓	<input checked="" type="checkbox"/> Good <input type="checkbox"/> Avg. <input type="checkbox"/> Bad
15.	Steel check - floating columns	-	<input type="checkbox"/> Good <input type="checkbox"/> Avg. <input type="checkbox"/> Bad
16.	Steel check - slab extensions/ joints	✓	<input checked="" type="checkbox"/> Good <input type="checkbox"/> Avg. <input type="checkbox"/> Bad

Remarks:

- Note: ① Rod bending work was not satisfactory
- ② In two beam's extra rods not provided.
- ③ Slab extra bars also not provided properly.
- ④ Covering blocks for slab and beam's are not provided properly.

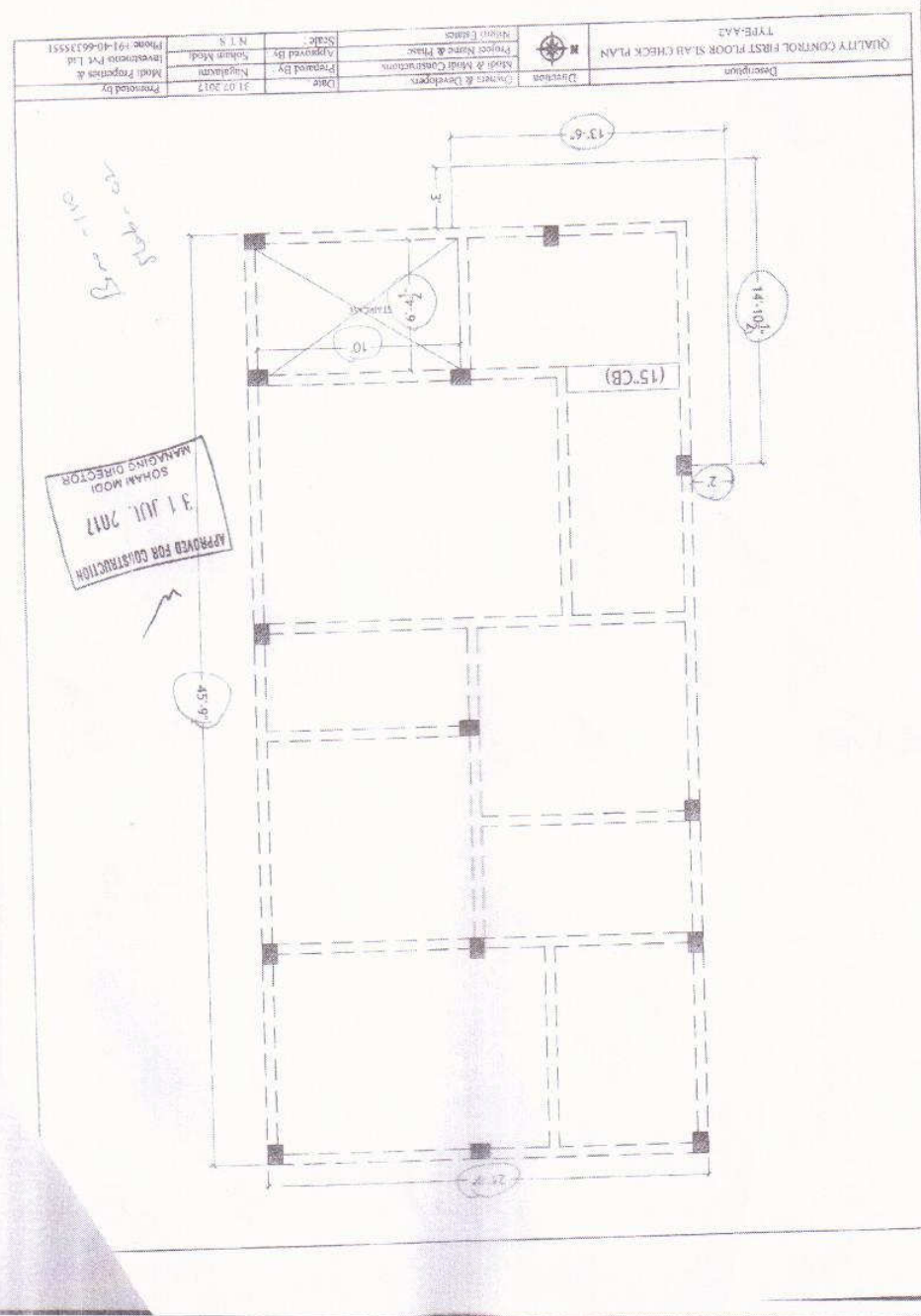

Description		Contract & Developer	
QUALITY CONTROL FIRST FLOOR SLAB CHECK PLAN		Modi & Modi Construction	
TYPE: A2		Project Name & Phase	
Project Name & Phase		Scale	
Contract & Developer		N.T.S.	
Modi & Modi Construction		Approved By	
Project Name & Phase		Soham Modi	
Contract & Developer		Prepared By	
Modi & Modi Construction		Nishant Modi	
Project Name & Phase		Date	
Contract & Developer		31.07.2017	
Modi & Modi Construction		Prepared by	
Project Name & Phase		Soham Modi	
Contract & Developer		Phone: 91-40-66315551	

APPROVED FOR CONSTRUCTION
 31 JUL 2017
 SOHAM MODI
 MANAGING DIRECTOR

Slab - 02
 Row - 110