

ATR on Quality Control Check Report. (Bungalows)

Bungalow No	15	QC report stage	Column - 2	Sl. No.	29160
Company	KJM	Project	Bloomdale	Phase	—
Prepared by		Sign		Date	
Project Manager		Sign	For Signature	Date	12/02/18
Receipt by QC date		Sign		Other	
Receipt at HO date		Sign		Other	
Checked By MD on		MD Sign		For filling	<input type="checkbox"/> Yes <input type="checkbox"/> No

Recommendation that was made by QC:

Stop further work. Submit ATR on QC report to QC team. Proceed only after recheck by QC.

Stop further work. Proceed with work after submitting ATR on QC report to QC team.

Notes:

1. Attach a copy of the QC report to this sheet.
2. Circle each correction with a red pen – tick (✓) each circle for work completed and cross (X) each circle where work has not been completed.
3. Give remarks for each case where work has not completed on this sheet.
4. Make 2 copied of the ATR – send one to MD and other to QC.
5. Enclose required photographs – hard copy.

Remarks:

① The mistake has been corrected to column, C ₂ 8 C ₄ .
② The honey comb's packing also completed.

Block No.	15	Column No.	02	Sl. No.	29160
Company	KJM	Project	Blomdale	Phase	---
Prepared by	P. Sri Kumar	Sign	<i>P. Sri Kumar</i>	Date	30/11/18
Project Manager	Radaramani Prabhu	Sign	<i>Radaramani Prabhu</i>	Date	30/11/18
Previous stage report no.	29004	Report filed and signed by PM?	<input checked="" type="checkbox"/> Yes <input type="checkbox"/> No		
Checked By	MD on	MD Sign		For filling	<input type="checkbox"/> Yes <input type="checkbox"/> No

Recommendation:

- Stop further work. Submit ATR on QC report to QC team. Proceed only after recheck by QC.
- Stop further work. Proceed with work after submitting ATR on QC report to QC team.
- Proceed with further work only after making corrections pointed out in the QC report. ATR not required.
- Proceed with further work. ATR not required.

Columns Position Check

Notes:

1. Inspection should be done after casting of columns at each stage and before starting centering works for each slab.
2. Prepare Columns Position Check Plan as follows:
 - a. Divide blocks into smaller sub-blocks.
 - b. Show size and orientation of columns. (Tolerance 0.5")
 - c. Show inner - inner space between columns. (Tolerance 1")
 - d. Show diagonals for 20% of bays. (Tolerance 1.5")
 - e. Print an A3 size plan.
3. Circle each correct dimension with green colour. Circle each incorrect dimension with red colour and mention actual dimension next to it.

Columns Position Check Plan enclosed?	<input checked="" type="checkbox"/> Yes <input type="checkbox"/> No
---------------------------------------	---

Slab Dimensions Check

Notes:

1. Prepare Slab (or plinth beams) Dimensions Check Plan as follows:
 - a. Show outer dimensions of slab. (Tolerance 2")
 - b. Show length and width of balconies (Tolerance 1")
 - c. Show inner dimensions of ducts and lift well. (Tolerance 1")
 - d. Show location of sunken slab.
 - e. Print an A3 size plan.
2. Circle each correct dimension with green colour. Circle each incorrect dimension with red colour and mention actual dimension next to it.

Slab Dimensions Check Plan enclosed?	<input checked="" type="checkbox"/> Yes <input type="checkbox"/> No		
Specified thickness of slab?	4 1/2"	Actual thickness of slab?	4 1/2"

Quality of centering, rod bending and concreting.	<input type="checkbox"/> Good <input type="checkbox"/> Avg. <input checked="" type="checkbox"/> Bad
Quality of centering, rod bending and concreting?	<input type="checkbox"/> Good <input type="checkbox"/> Avg. <input checked="" type="checkbox"/> Bad
Quality of starters?	<input checked="" type="checkbox"/> High <input type="checkbox"/> Medium. <input type="checkbox"/> Low
Number and size of honey combs?	<input type="checkbox"/> Good <input type="checkbox"/> Avg. <input checked="" type="checkbox"/> Bad
Are the honey combs is slab and columns packed?	
Number of beams that are sagging, bulging, caved or deflected in the slab by more than 1"	<input checked="" type="checkbox"/> Yes <input type="checkbox"/> No
Have 6 cubes each for columns and slab casted and numbered for testing?	
Remarks: Note: (1) Very poor concreting work done, honey combs packing also not done for columns.	

<u>Curing</u>	
Bunds for curing made on slab?	<input checked="" type="checkbox"/> Yes <input type="checkbox"/> No
Bund size is less than 100 sft?	<input checked="" type="checkbox"/> Yes <input type="checkbox"/> No
Drum (200 lbs) provided for curing?	<input type="checkbox"/> Yes <input checked="" type="checkbox"/> No
Gunny bags used for column curing?	<input checked="" type="checkbox"/> Yes <input type="checkbox"/> No
Distance of lap from furthest distance that requires curing. (max permitted 100')	30' 0"
Frequency of curing in number of times a day (enquire from labourers)	2 times
Is the pressure in the curing pipe more than 15' head?	<input checked="" type="checkbox"/> Yes <input type="checkbox"/> No
Quality of infrastructure for curing.	<input type="checkbox"/> Good <input checked="" type="checkbox"/> Avg. <input type="checkbox"/> Bad
Remarks:	

Quality Control Check Report Stage: After Column Casting (villas)

Columns height, plumb, steel & level marking check.

Notes:

1. Mark ✓ for correct or minor mistake which does not require correction
2. Mark ✗ for minor mistake that requires minor correction.
3. Mark ✗✗ for major mistake that requires correction by replacement or re-fixing.
4. Mark ✗✗✗ for major mistake that cannot be corrected
5. Tolerance: Plumb 0.25"
6. Circle actual height of columns if level differs from specified height by more than 1"

S No	Col No.	Col type	Height in ft		Steel (✓ or ✗)		Honeycombs	Plumb (✓ or ✗)		Reference level marked on column?
			Spec.	Actual	No of rods	Size of rods		Side 1	Side 2	
1.	—	C4	8'-2 1/2"	8'-2 1/2"	✓	✓	✓	✓	<input checked="" type="checkbox"/> Yes <input type="checkbox"/> No	
2.	—	C2	8'-4 1/2"	8'-4"	✓	✓	✓	✓	<input checked="" type="checkbox"/> Yes <input type="checkbox"/> No	
3.	—	C3	8'-4 1/2"	8'-5"	✓	✓	✓	✓	<input checked="" type="checkbox"/> Yes <input type="checkbox"/> No	
4.	—	C4	8'-2 1/2"	8'-2"	✓	✓	✓	✓	<input checked="" type="checkbox"/> Yes <input type="checkbox"/> No	
5.	—	C4	8'-2 1/2"	8'-2"	✓	✓	✓	✓	<input checked="" type="checkbox"/> Yes <input type="checkbox"/> No	
6.	—	C5	8'-2 1/2"	8'-2"	✓	✓	✓	✓	<input checked="" type="checkbox"/> Yes <input type="checkbox"/> No	
7.	—	C4	8'-2 1/2"	8'-2"	✓	✓	✓	✓	<input checked="" type="checkbox"/> Yes <input type="checkbox"/> No	
8.	—	C4	8'-2 1/2"	8'-3"	✓	✓	✓	✓	<input checked="" type="checkbox"/> Yes <input type="checkbox"/> No	
9.	—	C4	8'-2 1/2"	8'-2"	✓	✓	✓	✓	<input checked="" type="checkbox"/> Yes <input type="checkbox"/> No	
10.	—	C5	8'-2 1/2"	8'-2"	✓	✓	✓	✓	<input checked="" type="checkbox"/> Yes <input type="checkbox"/> No	
11.	—	C1	8'-1 1/2"	8'-1"	✓	✓	✓	✓	<input checked="" type="checkbox"/> Yes <input type="checkbox"/> No	
12.	—	C4	8'-4 1/2"	8'-4"	✓	✓	✓	✓	<input checked="" type="checkbox"/> Yes <input type="checkbox"/> No	
13.	—	C3	8'-2 1/2"	8'-2"	✓	✓	✓	✓	<input checked="" type="checkbox"/> Yes <input type="checkbox"/> No	
14.	—	C4	8'-4 1/2"	8'-4"	✓	✓	✓	✓	<input checked="" type="checkbox"/> Yes <input type="checkbox"/> No	
15.	—	C4	8'-2 1/2"	8'-2"	✓	✓	✓	✓	<input checked="" type="checkbox"/> Yes <input type="checkbox"/> No	
16.	—	C1	8'-1 1/2"	8'-2"	✓	✓	✓	✓	<input checked="" type="checkbox"/> Yes <input type="checkbox"/> No	
17.									<input type="checkbox"/> Yes <input type="checkbox"/> No	
18.									<input type="checkbox"/> Yes <input type="checkbox"/> No	
19.									<input type="checkbox"/> Yes <input type="checkbox"/> No	
20.									<input type="checkbox"/> Yes <input type="checkbox"/> No	

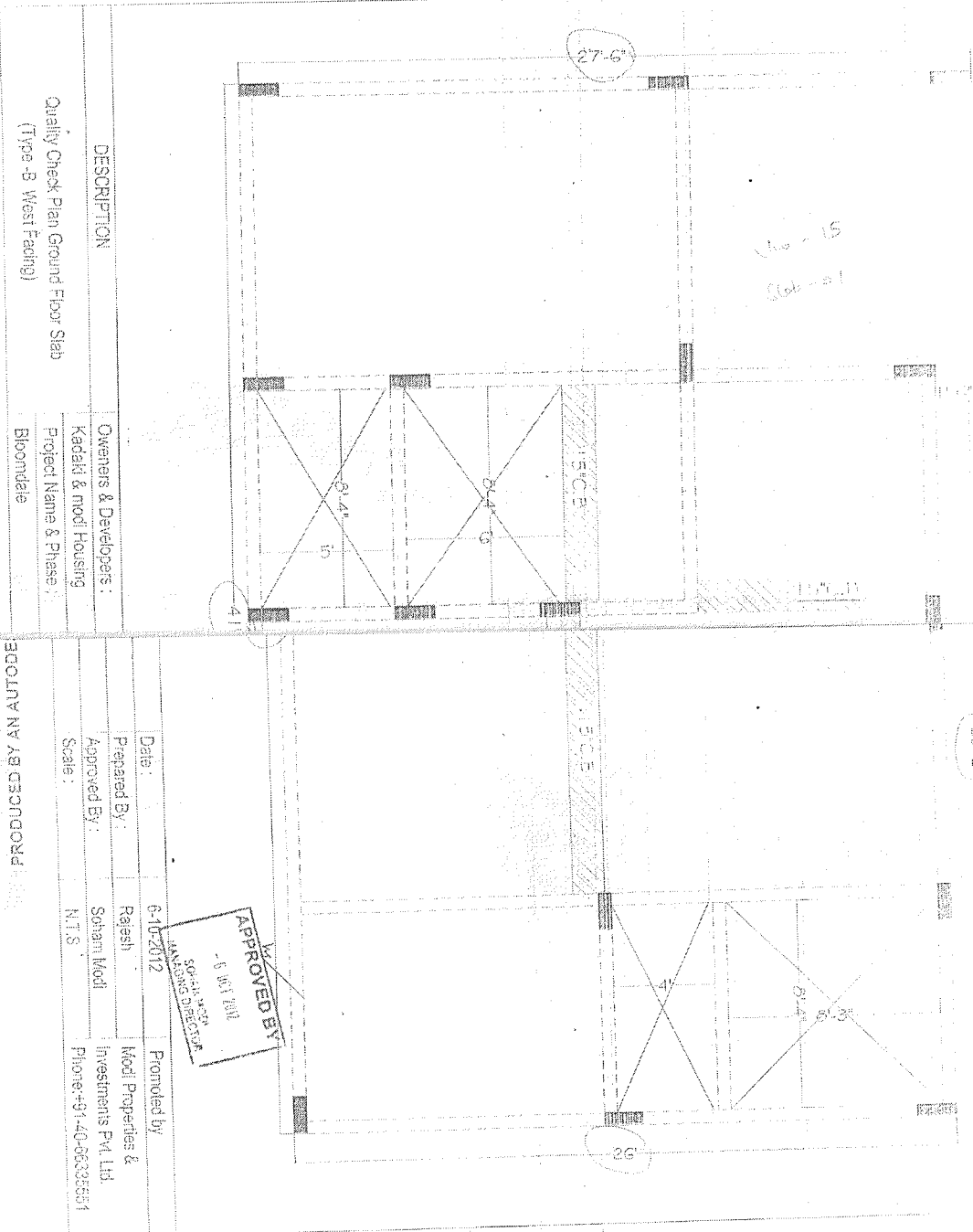

DESCRIPTION
 Quality Check Plan Ground Floor Slab
 (Type-B West Facing)

Owners & Developers :
 Kaddi & Modi Housing
 Project Name & Phase :
 Biondale

Date : 6-10-2012
 Prepared By : Rajesh
 Approved By : Soham Modi
 Scale : N.T.S.
 Promoted by : Modi Properties & Investments Pvt. Ltd.
 Phone: +91-40-36335551

APPROVED BY
 - 6 OCT 2012
 SOHAM MODI
 ASSISTANT DIRECTOR