

**Quality Control Check Report. Stage: Before Casting Plinth Beam (Villas)**

Block No.	23	Sl. No.	32024
Company	Severe Construction	Phase	→
Prepared by	P. Sai Kumar	Date	10/11/18
Project Manager	Sarwan	Date	10/11/18
Previous stage report no.	30983	Report filed and signed by PM?	<input checked="" type="checkbox"/> Yes <input type="checkbox"/> No
Checked By MD on	MD Sign	For filling	<input type="checkbox"/> Yes <input type="checkbox"/> No

**Recommendation:**

- Stop further work. Submit ATR on QC report to QC team. Proceed only after recheck by QC.
- Stop further work. Proceed with work after submitting ATR on QC report to QC team.
- Proceed with further work only after making corrections pointed out in the QC report. ATR not required.
- Proceed with further work. ATR not required.

**Plinth Beam Check.**

**Notes:**

1. Inspection should be done before casting of plinth beam.
2. Yellow enamel paint to be used for marking FFL of flooring. Mark 2" above FFL on column steel. Plinth beam top must be 2'3" (in case of pavers) or 2'4" (in case of RCC slab) below the mark.
3. Prepare plinth beam Dimensions Check Plan as follows:
  - a. Show outer dimensions. (Tolerance 2")
  - b. Show length and width of plinth beams (Tolerance 1")
  - c. Print an A3 size plan.
4. Circle each correct dimension with green colour. Circle each incorrect dimension with red colour and mention actual dimension next to it.
5. Project managers must make pedestal/column 0 self check report similar to report for column check. QC must collect report and attach the same to this report.

Plinth Beam Dimensions Check Plan enclosed?  Yes  No

**ATR on Quality Control Check Report. (Bungalows)**

Bungalow No	23	QC report stage	<del>Phase I</del>	SI. No.	32024
Company	SERENE CONSTRUCTION HYDRA	Project	SERENE FARMS	Phase	
Prepared by	T. Saikrishna	Sign	<i>[Signature]</i>	Date	13/11/18
Project Manager	Sarwar	Sign	Syed ghalam Sum	Date	13/11/18
Receipt by QC date		Sign		Other	
Receipt at HO date		Sign		Other	
Checked By MD on		MD Sign		For filling	<input checked="" type="checkbox"/> Yes <input type="checkbox"/> No

Recommendation that was made by QC:

- Stop further work. Submit ATR on QC report to QC team. Proceed only after recheck by QC.  
 Stop further work. Proceed with work after submitting ATR on QC report to QC team.

**Notes:**

1. Attach a copy of the QC report to this sheet.
2. Circle each correction with a red pen - tick (✓) each circle for work completed and cross (X) each circle where work has not been completed.
3. Give remarks for each case where work has not completed on this sheet.
4. Make 2 copied of the ATR - send one to MD and other to QC.
5. Enclose required photographs - hard copy.

Remarks: NOTE: POINTS which are mentioned by QC is corrected.

---



---



---



---



---



---



---



---

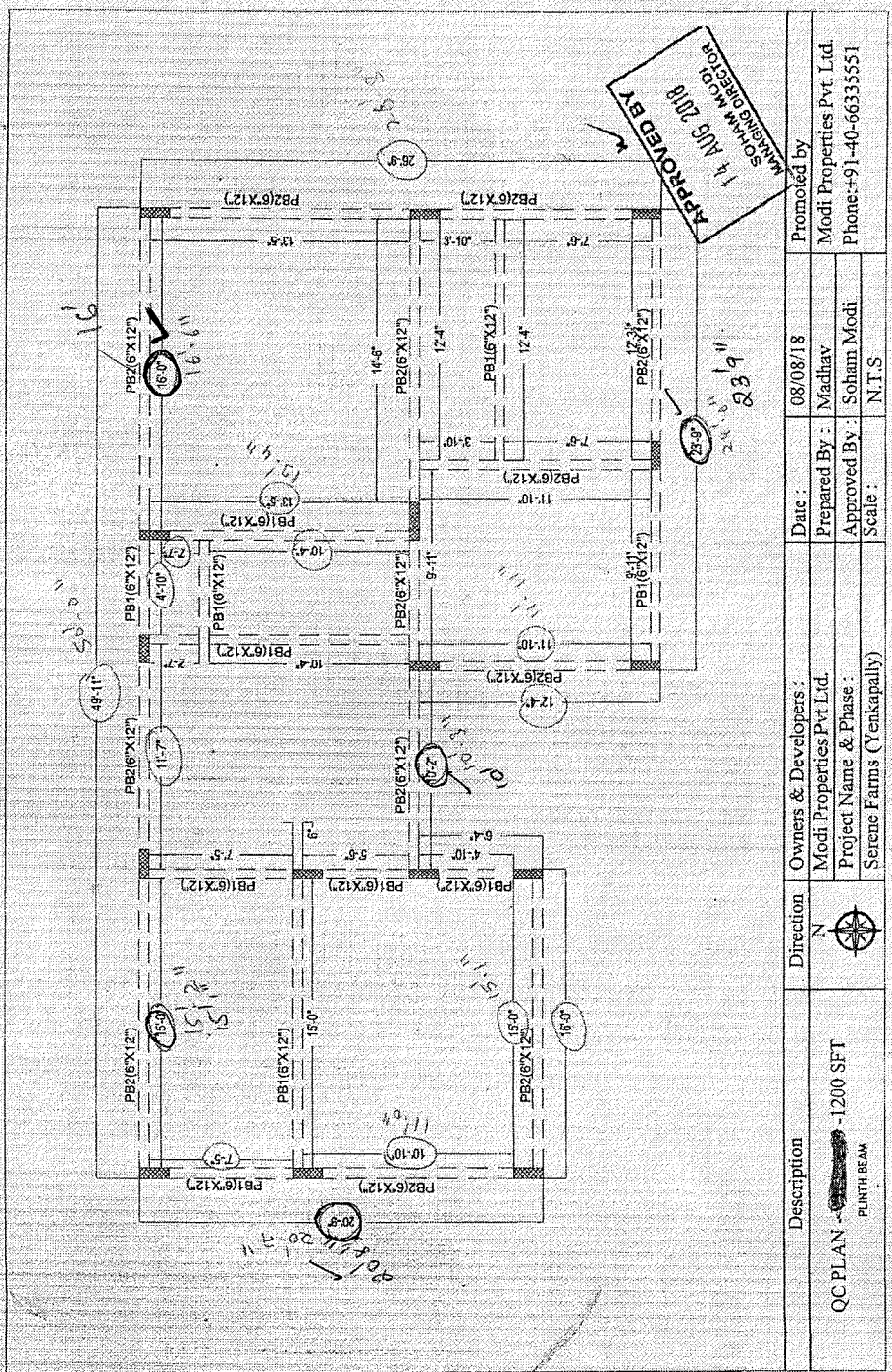

Description	Direction	Owners & Developers :	Date :	Promoted by
QC PLAN - 1200 SFT PLINTH BEAM	N	Modi Properties Pvt Ltd. Project Name & Phase : Serene Farms (Venkapatly)	08/08/18 Prepared By : Madhav Approved By : Soham Modi Scale : N.T.S	Modi Properties Pvt. Ltd. Phone: +91-40-66335551

Quality Control Check Repot.      Stage: Before Casting Plinth Beam (Villas)

S No	Item	Quantitative Check (✓ or X)	Qualitative Check (Good / Avg. / Bad)
1.	Steel Check - Beam no of rods	✓	<input checked="" type="checkbox"/> Good <input type="checkbox"/> Avg. <input type="checkbox"/> Bad
2.	Steel Check - Beam size of bars	✓	<input checked="" type="checkbox"/> Good <input type="checkbox"/> Avg. <input type="checkbox"/> Bad
3.	Steel Check - Beams Extra Bars	✓	<input checked="" type="checkbox"/> Good <input type="checkbox"/> Avg. <input type="checkbox"/> Bad
4.	Steel Check - Beams Overlapping & Cranking	✓	<input checked="" type="checkbox"/> Good <input type="checkbox"/> Avg. <input type="checkbox"/> Bad
5.	Steel Check - Beams Bearing	✓	<input checked="" type="checkbox"/> Good <input type="checkbox"/> Avg. <input type="checkbox"/> Bad
6.	Covering blocks for beams	✓	<input checked="" type="checkbox"/> Good <input type="checkbox"/> Avg. <input type="checkbox"/> Bad
7.	Depth and width of beams	✓	<input type="checkbox"/> Good <input checked="" type="checkbox"/> Avg. <input type="checkbox"/> Bad
Remarks:			

Quality Control Check Report      Stage: Before Casting Plinth Beam (Villas)

Quality of centering, rod bending and concreting.	<input type="checkbox"/> Good <input checked="" type="checkbox"/> Avg. <input type="checkbox"/> Bad
Quality of centering, rod bending and concreting?	<input type="checkbox"/> Yes <input type="checkbox"/> No <input checked="" type="checkbox"/> NA
Have rods for staircase slab been provided?	<input type="checkbox"/> Good <input checked="" type="checkbox"/> Avg. <input type="checkbox"/> Bad
Quality of Bracing Provided?	<input type="checkbox"/> Good <input checked="" type="checkbox"/> Avg. <input type="checkbox"/> Bad
Alignment of beams on outer side?	<input type="checkbox"/> Good <input checked="" type="checkbox"/> Avg. <input type="checkbox"/> Bad
Brackets for elevation features provided?	<input type="checkbox"/> Yes <input type="checkbox"/> No <input checked="" type="checkbox"/> NA
Level marking at 2' above P.I. is made?	<input checked="" type="checkbox"/> Yes <input type="checkbox"/> No
Column steel overlapping and cranking? (overlapping length should be 45 to 50 D)	<input checked="" type="checkbox"/> Correct <input type="checkbox"/> Needs correction
Pedestal/column 0 – self check report attached?	<input type="checkbox"/> Yes <input checked="" type="checkbox"/> No
Remarks:	

Plinth Beam Steel check.

Notes:

1. Mark ✓ for correct or minor mistake which does not require correction
2. Mark X for minor mistake that requires minor correction.
3. Mark X X for major mistake that requires correction by replacement or re-fixing.
4. Mark X X X for major mistake that cannot be corrected.
5. Columns overlapping length should be 45 to 50 D.