

ATR on Quality Control Check Report (Apartments)

Flat No	W16-N0-32	QC report stage		Sl. No.	
Company	KVM	Project	BUDMORALE	Phase	
Prepared by		Sign		Date	
Project Manager	Shivshankar	Sign		Date	30/06/12
Receipt by QC date		Sign		Other	
Receipt at HO date		Sign		Other	
Checked By MD on		MD Sign		For filling	<input type="checkbox"/> Yes <input type="checkbox"/> No

Recommendation that was made by QC:
 Stop further work. Submit ATR on QC report to QC team. Proceed only after recheck by QC.
 Stop further work. Proceed with work after submitting ATR on QC report to QC team.

Notes:

1. Attach a copy of the QC report to this sheet.
2. Circle each correction with a red pen - tick (✓) each circle for work completed and cross (X) each circle where work has not been completed.
3. Give remarks for each case where work has not completed on this sheet.
4. Make 2 copied of the ATR - send one to MD and other to QC.
5. Enclose required photographs - hard copy.

Remarks:

1. Error was on the parking column, which was error done by 1/2" in the 2nd floor and the ground floor it was 1".

Block No.	37	Column No.	II	Sl. No.	27454
Company	KNM	Project	Bhokarda	Phase	
Prepared by	S. Sunil Kumar	Sign	<i>[Signature]</i>	Date	24/06/17
Project Manager	K. Sarish	Sign	<i>[Signature]</i>	Date	
Previous stage report no.		Report filed and signed by PM?	27318	<input type="checkbox"/> Yes <input checked="" type="checkbox"/> No	
Checked By MD on		MD Sign		For filling	<input type="checkbox"/> Yes <input type="checkbox"/> No

Recommendation:

- Stop further work. Submit ATR on QC report to QC team. Proceed only after recheck by QC.
- Stop further work. Proceed with work after submitting ATR on QC report to QC team.
- Proceed with further work only after making corrections pointed out in the QC report. ATR not required.
- Proceed with further work. ATR not required.

Columns Position Check

Notes:

1. Inspection should be done after casting of columns at each stage and before starting centering works for each slab.
2. Prepare Columns Position Check Plan as follows:
 - a. Divide blocks into smaller sub-blocks.
 - b. Show size and orientation of columns. (Tolerance 0.5")
 - c. Show inner - inner space between columns. (Tolerance 1")
 - d. Show diagonals for 20% of bays. (Tolerance 1.5")
 - e. Print an A3 size plan.
3. Circle each correct dimension with green colour. Circle each incorrect dimension with red colour and mention actual dimension next to it.

Columns Position Check Plan enclosed? Yes No

Slab Dimensions Check

Notes:

1. Prepare Slab (or plinth beams) Dimensions Check Plan as follows:
 - a. Show outer dimensions of slab. (Tolerance 2")
 - b. Show length and width of balconies (Tolerance 1")
 - c. Show inner dimensions of ducts and lift well. (Tolerance 1")
 - d. Show location of sunken slab.
 - e. Print an A3 size plan.
2. Circle each correct dimension with green colour. Circle each incorrect dimension with red colour and mention actual dimension next to it.

Slab Dimensions Check Plan enclosed?	<input checked="" type="checkbox"/> Yes <input type="checkbox"/> No
Specified thickness of slab?	4 1/2" Actual thickness of slab? 4 1/2"

Quality Control Check Report Stage: After Column Casting (villas)

Quality of centering, rod bending and concreting.		<input type="checkbox"/> Good <input checked="" type="checkbox"/> Avg. <input type="checkbox"/> Bad
Quality of centering, rod bending and concreting?		<input type="checkbox"/> Good <input checked="" type="checkbox"/> Avg. <input type="checkbox"/> Bad
Quality of starters?		<input type="checkbox"/> High <input checked="" type="checkbox"/> Medium. <input type="checkbox"/> Low
Number and size of honey combs?		<input type="checkbox"/> Good <input checked="" type="checkbox"/> Avg. <input type="checkbox"/> Bad
Are the honey combs slab and columns packed?		
Number of beams that are sagging, bulging, caved or deflected in the slab by more than 1"		
Have 6 cubes each for columns and slab casted and numbered for testing?		<input checked="" type="checkbox"/> Yes <input type="checkbox"/> No
Remarks:		

<u>Curing.</u>		
Bunds for curing made on slab?	<input checked="" type="checkbox"/> Yes <input type="checkbox"/> No	
Bundle size is less than 100 sqft?	<input checked="" type="checkbox"/> Yes <input type="checkbox"/> No	
Drum (200 lts) provided for curing?	<input checked="" type="checkbox"/> Yes <input type="checkbox"/> No	
(Junny bags used for column curing?	<input checked="" type="checkbox"/> Yes <input type="checkbox"/> No	
Distance of tap from furthest distance that requires curing. (max permitted 100')		
Frequency of curing in number of times a day (enquire from labourers)		2 times.
Is the pressure in the curing pipe more than 15' head?	<input checked="" type="checkbox"/> Yes <input type="checkbox"/> No	
Quality of infrastructure for curing.	<input type="checkbox"/> Good <input checked="" type="checkbox"/> Avg. <input type="checkbox"/> Bad	
Remarks:		

Columns height, plumb, steel & level marking check.

Notes:

1. Mark for correct or minor mistake which does not require correction
2. Mark for minor mistake that requires minor correction.
3. Mark for major mistake that requires correction by replacement or re-fixing.
4. Mark for major mistake that cannot be corrected.
5. Tolerance: Plumb 0.25"
6. Circle actual height of columns if level differs from specified height by more than 1"

S No	Col No.	Col type	Height in ft		Steel (✓ or X)		Honeycombs	Plumb (✓ or X)		Reference level marked on column?
			Spec.	Actual	No of rods	Size of rods		Side 1	Side 2	
1.	A1	C4	8'-1 1/2"	8'-6"	✓	✓	✓	✓	✓	<input checked="" type="checkbox"/> Yes <input type="checkbox"/> No
2.	A2	C2	8'-1 1/2"	8'-0"	✓	✓	✓	✓	✓	<input checked="" type="checkbox"/> Yes <input type="checkbox"/> No
3.	A3	C3	8'-1 1/2"	8'-0"	✓	✓	✓	✓	✓	<input checked="" type="checkbox"/> Yes <input type="checkbox"/> No
4.	A4	C2	8'-1 1/2"	8'-6"	✓	✓	✓	✓	✓	<input checked="" type="checkbox"/> Yes <input type="checkbox"/> No
5.	B1	C3	8'-1 1/2"	8'-6"	✓	✓	✓	✓	✓	<input checked="" type="checkbox"/> Yes <input type="checkbox"/> No
6.	B2	C2	8'-1 1/2"	8'-6"	✓	✓	✓	✓	✓	<input checked="" type="checkbox"/> Yes <input type="checkbox"/> No
7.	B4	C2	8'-1 1/2"	8'-6"	✓	✓	✓	✓	✓	<input checked="" type="checkbox"/> Yes <input type="checkbox"/> No
8.	B5	C2	8'-1 1/2"	8'-0"	✓	✓	✓	✓	✓	<input checked="" type="checkbox"/> Yes <input type="checkbox"/> No
9.	C3	C3	8'-1 1/2"	8'-1"	✓	✓	✓	✓	✓	<input checked="" type="checkbox"/> Yes <input type="checkbox"/> No
10.	D2	C5	8'-7 1/2"	8'-6"	✓	✓	✓	✓	✓	<input checked="" type="checkbox"/> Yes <input type="checkbox"/> No
11.	D3	C5	8'-1 1/2"	8'-1"	✓	✓	✓	✓	✓	<input checked="" type="checkbox"/> Yes <input type="checkbox"/> No
12.	E1	C2	8'-1 1/2"	8'-5"	✓	✓	✓	✓	✓	<input checked="" type="checkbox"/> Yes <input type="checkbox"/> No
13.	E2	C4	8'-7 1/2"	8'-6"	✓	✓	✓	✓	✓	<input checked="" type="checkbox"/> Yes <input type="checkbox"/> No
14.	E3	C4	8'-1 1/2"	8'-4"	✓	✓	✓	✓	✓	<input checked="" type="checkbox"/> Yes <input type="checkbox"/> No
15.	E5	C1	8'-1 1/2"	8'-1"	✓	✓	✓	✓	✓	<input checked="" type="checkbox"/> Yes <input type="checkbox"/> No
16.										<input type="checkbox"/> Yes <input type="checkbox"/> No
17.										<input type="checkbox"/> Yes <input type="checkbox"/> No
18.										<input type="checkbox"/> Yes <input type="checkbox"/> No
19.										<input type="checkbox"/> Yes <input type="checkbox"/> No
20.										<input type="checkbox"/> Yes <input type="checkbox"/> No

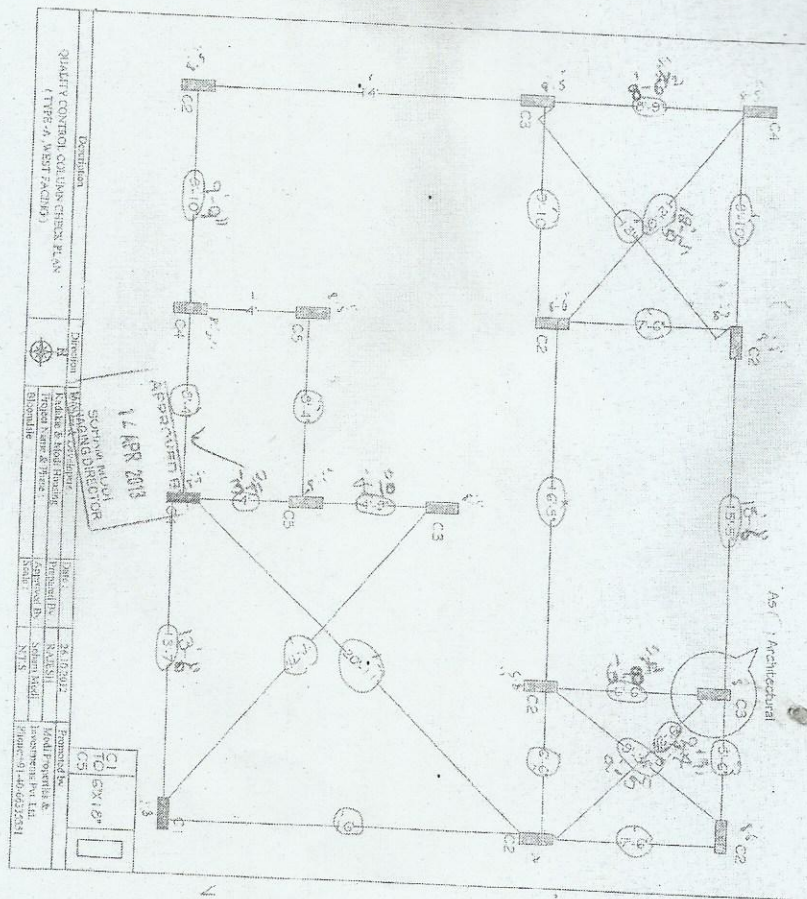

QUALITY CONTROL COLUMN CHECK PLAN
(TYPE-A, WEST FACING)

Destination
BENTON & BOWLES
Kolkata & Mohi, Bangalore
Project Name & Phase
Bipulshree

Prepared by: 24.10.2012
Checked by: RAJESH
Scale: 1:10
Drawing No: 14060203501

11 APR 2013
SCHEMATIC DIRECTOR

Column-27
Column-08