

The Residential Development Plan is hereby approved by the Director of Lands and Survey, Guyana, on 25-3-2006.

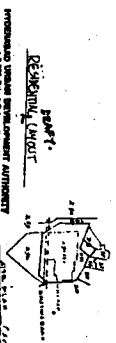
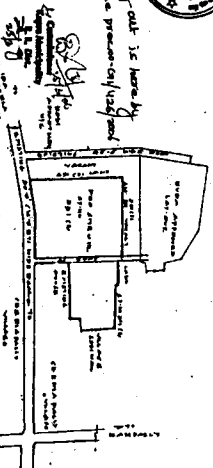

- The applicant has provided a site plan showing the layout of the development and the location of the roads and other infrastructure.
- The applicant has provided a detailed floor plan of the residential building showing the layout of the rooms and the location of the furniture.
- The applicant has provided a site plan showing the location of the development within the village of Palmwell, near the road network.
- The applicant has provided a detailed description of the development, including the number of lots, the area of each lot, and the area of the roads and other infrastructure.
- The applicant has provided a detailed description of the residential building, including the number of rooms, the area of each room, and the location of the furniture.
- The applicant has provided a detailed description of the water supply line, including the location of the line, the width of the line, and the clearance of the line.
- The applicant has provided a detailed description of the roads, including the location of the roads, the width of the roads, and the location of the sidewalks.
- The applicant has provided a detailed description of the other infrastructure, including the location of the other infrastructure, the width of the other infrastructure, and the location of the other infrastructure.
- The applicant has provided a detailed description of the other infrastructure, including the location of the other infrastructure, the width of the other infrastructure, and the location of the other infrastructure.
- The applicant has provided a detailed description of the other infrastructure, including the location of the other infrastructure, the width of the other infrastructure, and the location of the other infrastructure.

Signature
 Director of Lands and Survey
 Guyana

<p>PROPOSED LAY OUT SHOWING PLAN IN FIGURE 2 (10) OF RESIDENTIAL VILLAGE PALM WELL, EASTERN DISTRICT.</p> <p>APPLICANT TO: M. MANTA LOND CORP.</p> <p>REPRESENTED BY: MANABIR PAKRANI 10, GUYANA ROAD, 50, NE, SOUTH WEST.</p> <p>REFERENCE: LAY OUT BOARD REPORT WATER WORKS REPORT TOTAL ROAD WIDTH TOTAL LOT OUT AREA AREA EXPECTED UNDER ROAD WIDENING NET LOT OUT AREA</p> <p>REMARKS: B 60.00 HRS 90850.00 SQM 714.00 SQM 39598.00 SQM</p>	
<p>LAND USE ANALYSIS: PLANNED USE: 50-80% ROAD AREA: 5087.00 SQM OPEN AREA: 39000.00 SQM TOTAL AREA: 44087.00 SQM</p> <p>SCALE: 1:50.0</p> <p>APPLICANT'S SIGNATURE: <i>Signature</i></p> <p>APPLICANT'S NAME: MANTA LOND CORP.</p> <p>ADDRESS: 10, GUYANA ROAD, 50, NE, SOUTH WEST.</p>	