

I ESTIMATION OF ROAD LAYING & EARTH FILLING:

@ Rd # 12,

B. Hills.

- a) 40mm found = 05 loads @ 1750/- = 148750
- b) Baby chips = 04 loads @ 1900 = 147600
- c) Sand = 05 loads @ 4000 = 1420,000
- d) Cement = 120 bags @ 100 = 1412,000
- e) Miller charges = 02 Nos @ 850 = 141700
- f) Mud filling = 17 loads @ 200 = 143400
- g) Labour charges = 33008 ft @ 2.50 = 148250

1461,700

II. ESTIMATION OF BRICK WORK @ Rd # 12, B. Hills

a) Labour charges = $105'6'' \times 4' = 42288 \text{ ft} @ (1.75 + 1.25 + 1.9)$
= 142067.80

b) Solid blocks (6") = 640 Nos @ 11.75 = 147520

c) Sand = 01 load = 144000

d) Cement = 35 bags @ 100 = 143500

e) Aluminium window frames = $8' \times 5' \times 4 \text{ Nos} = 16088$
 $\Rightarrow 6'6'' \times 4' \times 4 \text{ Nos} = 10488$

26488 @ 150

= 1439,600

Total = 1456,687

The President / Secretary
Lami Co-operative Housing Society Ltd
Mahendra Hills
Lundreseed.

Subj: Payment of Developmental charges towards
Plt Nos. 140 & 141

Dear Sir,

I am enclosing two cheques of Rs 23,300 (Rupees
Twenty Three Thousand Three Hundred Only) each for
the payment of Development charge for plot nos
140 & 141 in the name of SYED MEHDI &
RAZIA BANO.

Kindly acknowledge the receipt.

Thank you

Sincerely yours

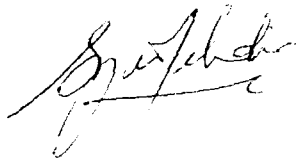

SYED MEHDI

Tel # 27616291

Landi 00966505699016

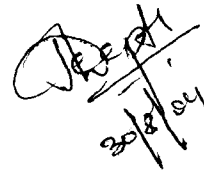
20/8/04

III ESTIMATION OF GRANITE EMBANKMENT:

a) No. of Cement bags = 40 bags @ 100 = Rs 4000

b) Dust = 02 loads @ 1300 = Rs 2600

c) Granite = 04 loads @ 500 = 2000 @ 4.75 = Rs 9500

d) Bindard = 06 loads @ 475 = Rs 2850

e) Labour charges = $42' \times 11' \times 4' = 1848 \text{ cft} @ 3/- (+ 10\% \text{ extra})$

= Rs 5544 + 554

= Rs 6098.4

f) Mud filling = 15 loads @ 200 = Rs 3000

Rs 28,048

Mehdi Bajara N/s.

CIA 76920

37/8/182004

PAY *Ram Cooperative Housing Society Ltd.*

या धारक को OR BEARER

रुपये RUPEES *Twenty Three Thousand
Three Hundred Only*

अदा करें

₹.Rs. 23,300/-

खा. सं.
A/c. No.ब.प.
LF.द.ह.
INTLS.भारतीय स्टेट बैंक
STATE BANK OF INDIAसिकन्दराबाद, हैदराबाद - 500 003
SECUNDERABAD, HYDERABAD - 500 003
MCAB 197*[Signature]*

⑈369904⑈ 500002037⑈

11

CIA 76920

37/8/182004

PAY *Ram Co-operative Housing Society Ltd.*

या धारक को OR BEARER

रुपये RUPEES *Twenty Three Thousand Three
Hundred Only*

अदा करें

₹.Rs. 23,300/-

खा. सं.
A/c. No.ब.प.
LF.द.ह.
INTLS.भारतीय स्टेट बैंक
STATE BANK OF INDIAसिकन्दराबाद, हैदराबाद - 500 003
SECUNDERABAD, HYDERABAD - 500 003
MCAB 197*[Signature]*

⑈369905⑈ 500002037⑈

11

Date: 13.04.2004

To,
The Secretary,
Ravi Co-operative Society,
Survey No. 74/3,
Maredpally,
SECUNDERABAD.

Dear Sir/Madam,

Sub: Application for 1/2 inch water connection and sewerage connection.

We have purchased Plot No.140 in Ravi Co-operative Society, Mahindra Hills, vide registered sale deed bearing No. 433/95, dated 31.08.1995. We have subsequently obtained sanction for construction, vide permission No. 648, dated 10.02.2003.

We have completed the construction of the house. We request you to provide a 1/2 inch municipal water connection to our premises. We have already laid the necessary pipes upto the society's main water pipe. At the moment there is no sewerage connection in front of my plot. We request you to provide us the sewerage connection upto my plot.

We are willing to pay the necessary fees/charges for provision of the same.

Thank You.

Yours Sincerely,
For SYIED MEHIDI,



SOHAM MODI
Managing Director

Encl:

1. Copy of sale deed.
2. Copy of Specific Power of Attorney

Date: 13.04.2004

To,
The Secretary,
Ravi Co-operative Society,
Survey No. 74/3,
Maredpally,
SECUNDERABAD.

Dear Sir/Madam,

Sub: Application for 1/2 inch water connection and sewerage connection.

We have purchased Plot No.141 in Ravi Co-operative Society, Mahindra Hills, vide registered sale deed bearing No. 435/95, dated 31.08.1995. We have subsequently obtained sanction for construction, vide permission No. 647, dated 10.02.2003.

We have completed the construction of the house. We request you to provide a 1/2 inch municipal water connection to our premises. We have already laid the necessary pipes upto the society's main water pipe. At the moment there is no sewerage connection in front of my plot. We request you to provide us the sewerage connection upto my plot.

We are willing to pay the necessary fees/charges for provision of the same.

Thank You.

Yours Sincerely,
For RAZIA BANO,



SOHAM MODI
Managing Director

Encl:

1. Copy of sale deed.
2. Copy of Specific Power of Attorney

*file in Mehdi
An Hills file*

sohammodi@hotmail.com

From: "syed mehdi" <mehdisyed@hotmail.com>
To: <sohammodi@hotmail.com>
Sent: Wednesday, October 15, 2003 4:44 AM
Attach: NRE ACCOUNT STATEMENT.htm
Subject: Re: Housing Loan

Dear Soham,

Regarding loan I need atleast Rs. 20,00,000/-in order to complete Mahendra Hills Project and regarding statement of NRE account can you check with the bank whether the statement downloaded through internet will do or they want print out from bank, if they insist then I can arrange from my bank also, any way I will email you can print and check with them., but I don't know the attachment will open or not if not I will fax you. All other requirements I can arrange without any problem.

Any news about rent and advance payment from Holool if you receive it you can ask accountant to deposit in your account at SBI and use it for expenses.

Regarding this loan you are talking about which bank so that I can download the application form and see other details.

That's all for now,

Regards

Mehdi

15-Oct-03

Media
Mahendra hills
Site

For only one Building

MATERIAL REQUIRMENT

	ITEM	QUNTITY	length of rod of 10m
1	steel		
	16@	900 kg	56 no
	12@	150 kg	17 no
	10@	570kg	93 no
	8@	250 kg	63 no
2	cement	62 bags	.
3	sand	4.5 m3	1160 cft
4	Balast	6 m3	112 cft
	For colum& footing	only	

Binding wire 50 kg

M. D. Attar Kar

by
7/8/03.

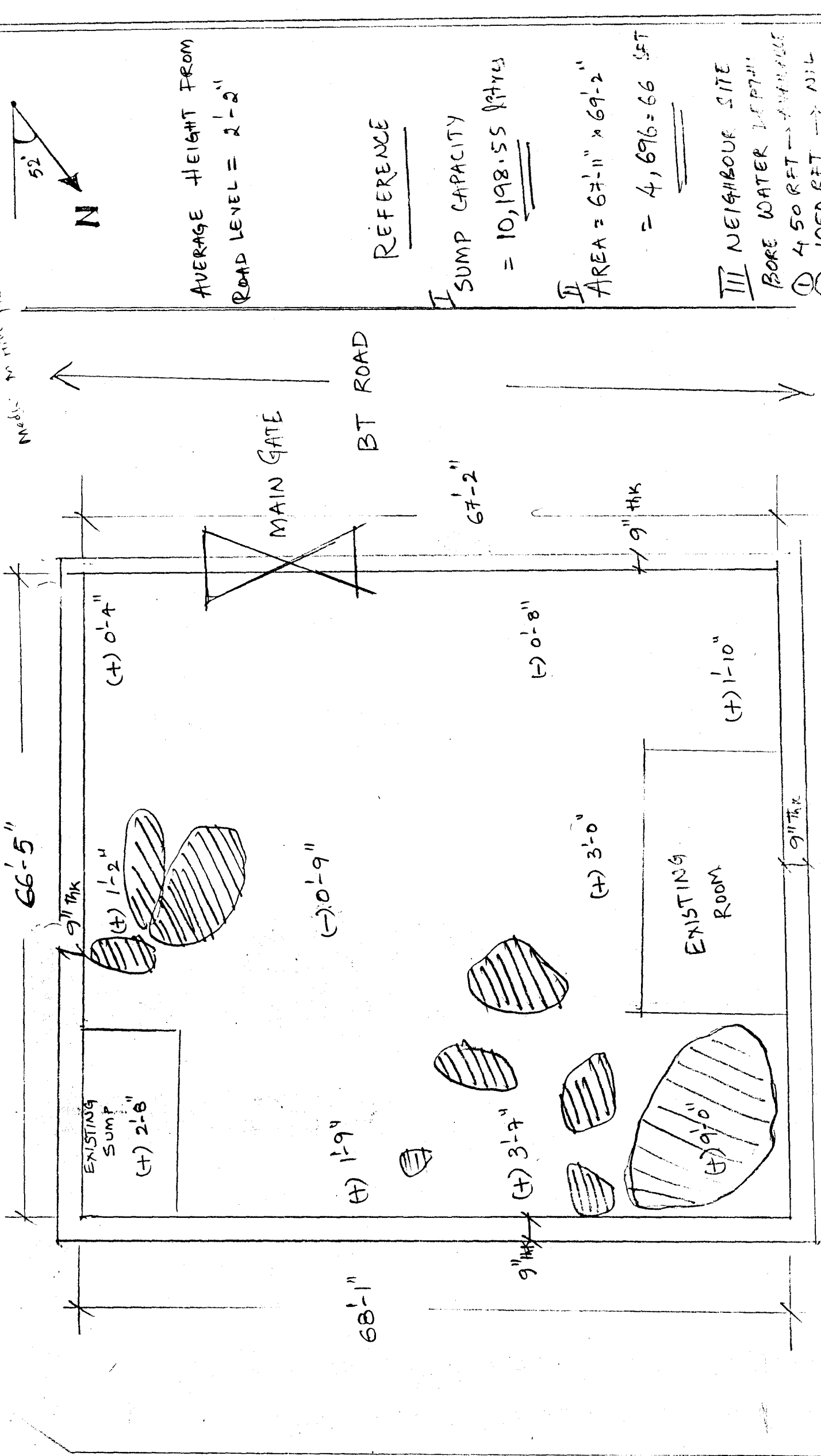

AVERAGE HEIGHT FROM
ROAD LEVEL = 2'-2"

REFERENCE

I SUMP CAPACITY
= 10,198.55 litres

II AREA = 67'-11" x 69'-2"
= 4,696 = 66 SET

III NEIGHBOUR SITE
BORE WATER DEPTH:
① 450 RFT → AVAILABLE
② 1050 RFT → NIL
③ 550 RFT → AVAILABLE

SITE:- BYED NEHALI PLOT # 140, 141, MAHENDRA HILLS

RAVI CO-OPERATIVE SOCIETY, MAREDRALLY - SEC-BAD

Soham Modi - Hotmail

From: "syed mehdi" <mehdisyed@hotmail.com>
To: <sohammodi@hotmail.com>
Sent: 05 June, 2003 12:43 AM
Subject: Re: Regd Mahendra hills site

Dear Soham,

Well regarding Mahendra Hills first they said to reduce height and we revised and submitted the drawings but still they sanctioned one floor only ok still I would like to go for G + 1 as I don't think there will be much problem as all other houses in the area are three floors etc.

Regarding work you can start the person who is incharge for the society is Mr. Sanjeeva Reddy his mobile Phone no. is 9849402779 Resi 27730371 he is ok already for the Society i had donated one truck of cement for Sai Baba mandir and one main door of teak wood which he said is for Rs. 20,000 so if require any sort of clarification and help for anything you can ask Mr. Kanaka Rao to contact him he will help us out.

My main concern is the area of site is low we will have to raise the building enough so that water flowing from hill should not enter you can have a look of house opposite to our site and they had raised enough from ground and also constructed G + 3.

Regarding budget our plan is to spend at the most Rs. 30,00,000 for both the houses, so you please try to control your best because Banjara project was something different for us whereas this is for rental purpose so from my side there will not be any additional request either in designing or construction items in order to control cost its all upto you.

Regarding windows of Aluminum, Marble and Ceramic is acceptable to me its your decision from my side my only concern is the area as it is low so we have to raise enough.

We already have the assesment done for Municipality Tax and Power supply for one house, in any case if we want three phase you will have to apply again.

Regarding bore well and stone cutting you can start immediately without any problem and one more request, my children wants it to be on their name and my wife is requesting you especially to erect a sign board as

CONSTRUCION OF KAMRAN
AND
FURQAN VILLA'S

I cannot think of this where to erect but as she is insisting you please try do it where ever you think it is appropriate.

By the way whats the progress for RM Mansion any way my Mom & Sister in law had visited the site and they are impressed with the work and also they liked green color of slopes.

Thats all for now.

Regards,

Mehdi

>From: "Soham Modi"
 >To: "syed mehdi"
 >Subject: Re: Regd funds transfer
 >Date: Wed, 4 Jun 2003 11:10:18 +0530

>

>Dear Medhi,

>

>The sanction plan of the Mahendra Hills site is only for one floor. The sanctioning authority has struck off the upper floor. Are you aware of it? Do you want to construct G + 1?

>

>I spoke to Subash Narain about the plan. He says the plan is OK and we should we go ahead with the same plan. At best we can convert the lobby on the 1st floor to a terrace in one of the two houses. I have asked him to go ahead and make the final plans.

>

>Can we start the construction immediately? We have to start with rock cutting, make a bore, apply for two three phase electricity meters and one water connection.

>

>I would advise that you make simple houses with simple specs like: Al windows, marble in drawing & dinning only, rest in ceramic, etc. In such a case the cost per house will be around 12 to 15 lacs. You will have to provide fans, tubelights, kitchen furniture & wardrobes in order to lease the premises. That may cost about 1 to 2 lacs per house. Since you are going to lease the premises the tenants are likely to spoil expensive items. Therefore we should avoid using expensive items.

>

>Regards,

>

>Soham Modi

ORIGINAL
A. P. C. P. D. C. L.
TEMPORARY RECEIPT

Mahendra

DD N^o 066895 100/- $\frac{040986}{6.10.01}$ Date...6...10...01.....200

Received from Syed Mehdi
P. No. 140 Kani Co of Society, m. Hsth
Rs (1865/-) one thousand eight hundred & sixty five only
on account of DD No 115570 Dt. 4.10.01
10% Supervisory of Dev. chgo
P. O. Supervisor

NOTE : The receipt is only temporary one and is only for seven days and is not binding on the Department unless supported by a receipt in the departmental from duly signed by the Accounts Officer, A.P.C.P.D.C.L.