

The Builder/Contractor should obtain the Metal, Stone, Bricks, Kapra Slabs, Earth Murrum and Gravel etc., from quarry lease holders with "ROYALTY TRANSIT FORM" issued by Mines and Geology Department and copy of the Proceedings shall be sent to the Assistant Director, Mines and Geology of the District.

Permission granted subject to the provisions of the Urban Land (Ceiling & Regulations) Act, 1976: Vide Proceedings No. BA/G 1358/2005-2006 Date: 20-9-2005 Amount Collected Rs: 6772/- the permission sanctioned is valid upto 19-9-08 Vide Receipt No: 153752 Dt: 8-9-05

PLAN SHOWING THE PROPOSED GROUND & FIRST FLOOR RESIDENTIAL BUNGALOW ON PLOT NO:55, FORMING A PART OF SURVEY NOS. 35 TO 39 SITUATED AT "SILVER OAK BUNGALOWS" CHERLAPALLY (V), KAPRA MUNICIPALITY, R. R. DIST. BELONGING TO: M/S MEHTA & MODI HOMES, REP. BY ITS MANAGING PARTNER MR. SOHAM MODI S/O. MR. SATISH MODI

SPECIFICATIONS

| | |
|--------------------------|---------------|
| 1. FOUNDATION | C.C.BED |
| 2. BASEMENT | C.R.S MASONRY |
| 3. SUPERSTRUCTURE | BRICK MASONRY |
| 4. COLUMNS, BEAMS, SLABS | R.C.C. 1:2:4 |
| 5. PLASTERING | C.M IN 1:4 |
| 6. FLOORING | MARBLE |
| 7. DOORS & WINDOWS | TEAK WOOD |

REFERENCE: JHONER

| | | |
|-----------------------|---------------|--------------|
| PROPOSED | D : 1.06X2.0 | W : 1.8X1.2 |
| EXISTING | D1 : 0.91X2.0 | W1 : 1.5X1.2 |
| SCALE : 1:100 & 1:200 | D2 : 0.76X2.0 | W2 : 1.2X1.2 |
| | V : 0.92X0.61 | W3 : 1.8X.91 |

AREAS

| | |
|----------------------------|----------------------------------|
| TOTAL PLOT AREA | 170.77 Sq.Mtrs (OR) 204.16Sq.Yds |
| GROUND PLINTH | 62.06 Sq.mtrs |
| FIRST PLINTH | 62.06 Sq.mtrs |
| TOTAL PLINTH AREA | 124.12 Sq.mtrs |
| FLOOR SPACE INDEX COVERAGE | 1:0.72 |
| OPEN AREA | 36% |
| COMPOUND WALL | 108.65 Sq.mtrs |
| | 53.35 Rmtr |

OWNERS SIGN ARCHITECT SIGN

For Mehta and Modi Homes
Soham Modi
 Partner

M. Raja Rao
 M. RAJA RAO D.ARCH.E
 Licensed Surveyor L.No.Q1/6734/99
 Kapra Municipality Hyderabad-62

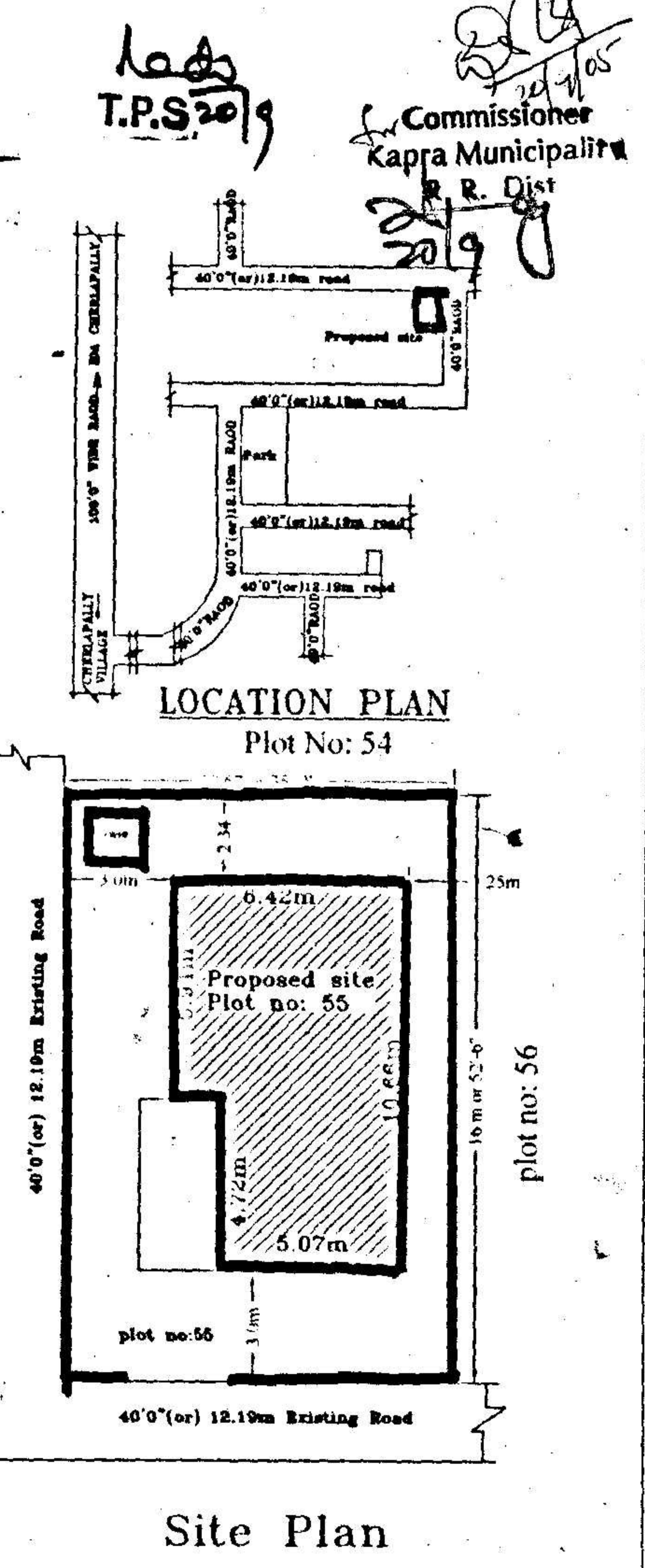
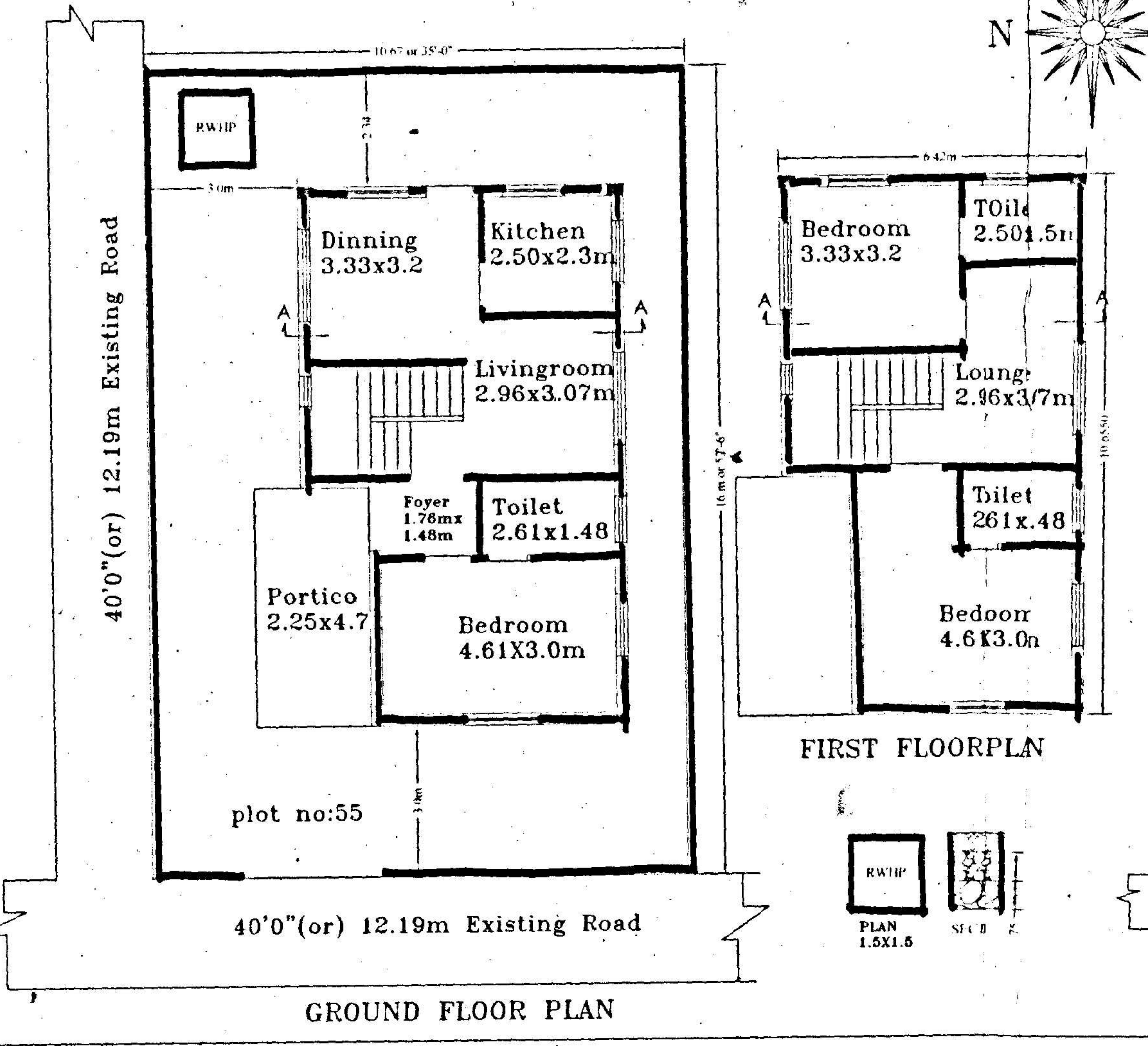

Commissioner
 Kapra Municipality
 R. R. Dist
 Hyderabad