

REGISTRATION PLAN OF PLOT NO 9 IN SURVEY

NO 2875 SITUATED AT RAMAKRISHNA NAGAR

COLONY AT CHEELA PALLY HYDERABAD EAST

VENDOR: SRI Y. SUBBARAO

W/O Y. V. SUBBA RAO

VENDEE: SRI. K. VALLA RAO MOHAN RAO.

S/O M. VENKATESWARA RAO



PLOT NO: 4

150'

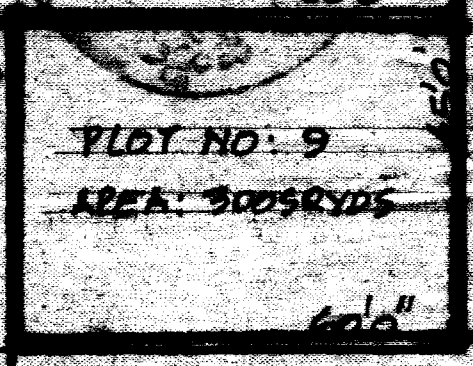

30' WIDE ROAD

30' WIDE ROAD

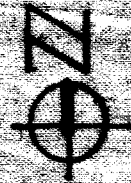

SCALE: 1" = 25' 0"

PLOT AREA: 9005 RYDS OR 250' 30" SQ.

BOUNDARIES

NORTH: PLOT NO: 8

SOUTH: 30' WIDE ROAD

EAST: 30' WIDE ROAD

WEST: PLOT NO: 7

INCLUDED

EXCLUDED

WITNESSES

1.

2.

THE NATIONAL BUREAU OF INVESTIGATION  
WASHINGTON, D. C. 20535  
UNITED STATES DEPARTMENT OF JUSTICE



UNITED STATES DEPARTMENT OF JUSTICE  
FEDERAL BUREAU OF INVESTIGATION  
WASHINGTON, D. C. 20535

WEST 30 FIVE ROAD  
EAST 30 FIVE ROAD  
SOUTH 30 WIDE ROAD  
NORTH 30 FIVE ROAD

APPROXIMATELY 100'

100' ON TOP