

PURCHASE DIVISION  
Advice for approval for credit to supplier

@

Date:		10-02-23		Prepared by	Venkatesh	Serial no.	14390
Supplier name		Linus Consultants 2021-23 Master				HO inward no.	
Firm/Company		MRMLLP		Project	GMR	HO received date	
PO/WO date		23-12-22		PO/WO No.	95352	Scan ID.	
Sl no.	Bill no.	Bill date	Bill amount	Original attached			
1.	122	13-01-23	60,180/-	<input checked="" type="checkbox"/> Yes <input type="checkbox"/> No			
2.				<input type="checkbox"/> Yes <input type="checkbox"/> No			
3.				<input type="checkbox"/> Yes <input type="checkbox"/> No			
4.				<input type="checkbox"/> Yes <input type="checkbox"/> No			
Amount A – Bills total (Excluding Transport & Hamali Charges):						60,180/-	
Proof of delivery by way of: <input type="checkbox"/> DCs/bill <input type="checkbox"/> Steel report <input type="checkbox"/> RMC pour report <input type="checkbox"/> Solid block report <input type="checkbox"/> Installation report							
MRN nos.:	116276				Proof of delivery matches MRN	<input checked="" type="checkbox"/> Yes <input type="checkbox"/> No	
Amount B –Other Credits : Transportation charges						—	
Amount C –Other Debits :						—	
Amount D (D=A+B-C) – Amount to be credited to the supplier:						60,180/-	
Amount E – PO / WO value:						60,180/-	
Amount F – Difference (A – E):						—	
Quantity received as per PO /WO				<input checked="" type="checkbox"/> Yes <input type="checkbox"/> Excess received <input type="checkbox"/> Short received <input type="checkbox"/> Part received			
Close PO / WO				<input checked="" type="checkbox"/> Yes <input type="checkbox"/> No – wait for balance material <input type="checkbox"/> Other			
Payment – due date				20-02-23			
Remarks: final bill							
Approved by	Purchase Officer	Purchase Manager	MD	Accountant	Accounts Manager		
Name:		V.ves					
Sign:							
Date		10 FEB 2023					
Approval limit	Upto 20k	Above 20k	Above 100k	Upto 20k	Above 20k		

Notes: 1. In case amount to be credited to supplier and the bills total does not match, accountants to prepare JV for debit or credit. 2. This set should only have 5 documents i.e., advice to credit to supplier, original bill, proof of delivery, original purchase order with barcode, original requisition. 3. Do not attach additional documents like weighment slips, RMC batch reports, duplicate documents, Eway bills, test reports, etc. 4. In Amount A, exclude transport, Hamali charges, etc., and instead include in Amount B. 5. This report must reach HO within one working day of approval by purchase officer/purchase manager.

## Tax Invoice

<b>LINUS CONSULTANTS 2021-23 MASTER</b> PLOT NO 38 ROAD NO 5 JUBILEE HILLS, HYDERABAD GSTIN/UIN: 36AAACL7034N1Z9 State Name : Telangana, Code : 36 E-Mail : ACCOUNTS@LCPL.CO.IN	Invoice No. <b>LCPL/22-23/122</b>	Dated <b>13-Jan-2023</b>
Consignee <b>MODI REALITY MALLAPUR LLP</b> SOHAM MANSION, M G ROAD, SECUNDERABAD GSTIN/UIN : 36AAEFM1459R1ZP State Name : Telangana, Code : 36	Supplier's Ref.	Other Reference(s)
Buyer (if other than consignee) <b>MODI REALITY MALLAPUR LLP</b> Gulmohar Residency, Survey No 19, Mallapur, Hyderabad GSTIN/UIN : 36AAEFM1459R1ZP State Name : Telangana, Code : 36		

SI No.	Particulars	HSN/SAC	Amount
1	<b>SUPPLY OF MODULAR CABINETS LOCAL</b>	94034000	<b>51,000.00</b>
2	<b>CGST OUTPUT</b>		<b>4,590.00</b>
3	<b>SGST OUTPUT</b>		<b>4,590.00</b>
	<b>Total</b>		<b>₹ 60,180.00</b>



Amount Chargeable (in words) E. & O.E  
**INR Sixty Thousand One Hundred Eighty Only**

HSN/SAC	Taxable Value	Central Tax		State Tax		Total Tax Amount
		Rate	Amount	Rate	Amount	
94034000	51,000.00	9%	4,590.00	9%	4,590.00	9,180.00
<b>Total</b>	<b>51,000.00</b>		<b>4,590.00</b>		<b>4,590.00</b>	<b>9,180.00</b>

Tax Amount (in words) : **INR Nine Thousand One Hundred Eighty Only**

Remarks:  
 PO NO 95352 / 23.12.2022. G-103  
 Company's PAN : **AAACL7034N**

Company's Bank Details  
 Bank Name : ICICI BANK AC 007605004157  
 A/c No. : 007605004157  
 Branch & IFS Code : JUBILEE HILLS & ICIC0000076

for LINUS CONSULTANTS 2021-23 MASTER

Authorised Signatory

## Purchase Order

Page(s) 1 Of 1

03-01-2023 15:14:14

Original / Office Copy / Purchase Div.Copy

From Company : **Modi Reality Mallapur LLP**  
5-4-187/3&3, II nd floor, Soham Mansion, MG Road, Secunderabad.  
G S T No. : 36AAEFM1459R1ZP

Supplier Details		Doc No	95352	208547
Linus Consultants Pvt.Ltd.		Doc Date	23-12-2022	
Plot 38,Rd,#5,,Jubile Hills, Hyd - 500033.		Quote No	Nil	
<b>GSTIN</b> 36AAACL7034N1Z9	23550861	Quote Date	23-12-2022	
23551855/23553929/23550781	7680022677/76	SupplyType	Supply	

**Kind Attn : Mr. Srikant**

Purchase Order for the Supply of following Items.

Item Name	Qty	Rate	Dis%	GST	Amount
1 117200 - FUNF-Furniture & fixtures - Kitchen cabinets-Laminated MDF-Wenge - - - sqm Closed Cabinet Type-A2-SFT	51.00	1,000.00	0.00	18.00	60,180.00
<b>Total Order Value . . .</b>					<b>60,180.00</b>

Rupees : Sixty Thousand One Hundred Eighty Only.

### Terms and Conditions :-

Specification / Brand	As per approved drawing, design & quotation & ltr. of conf. dt.18/11/2016 shall be applicable. Closed cabinete rate per sft Rs.1000/-
Payment Terms	50% adv. shall be paid at the time of W.O., bal. amount shall be paid within 7days of delivery of material and raising of invoice.
Tax	All taxes included in above price.
Delivery Date	Within 15days.
Delivery Location	Gulmohar Residency Survey No 19, Mallapur, Hyderabad. NExt to NFC Railway Over Bridge Phone. Contact: Security _____, 8309938133
Penalty For Delay	Nil
Transportation Cost	Included in above price
Warranty	1Yr from date of installation against any defects in manufacturing. Prompt & Regular service shall be given by you for repair.
Advance Paid	Rs.30,090.00
Other Terms	We reserve the right to reject items not conforming to quality and specifications. Above order for G-103 Modular kitchen work purpose.
Completion Date	Installation of the Modular Kitchen at site shall be done at our cost.
Measurment	You shall provide packing list along with delivery of material clearly specifying the items included.seperate pckng shall be made for each kitchen.
Security	Nil
Remarks	'Original invoice + copy of proof of delivery is required to process invoice for payment. DO NOT send original invoice to site. Original invoices must be sent to HO office or purchase site office. Proof of delivery/DC can be sent by email.'

For **Modi Reality Mallapur LLP**  
Authorised Signatory

Accepted the above Terms And Conditions  
For **Linus Consultants Pvt.Ltd.**

Name : \_\_\_\_\_

Name : \_\_\_\_\_

Date : \_\_\_/\_\_\_/\_\_\_

# Purchase Order

From Company : **Modi Reality Mallapur LLP**  
5-4-187/3&3, II nd floor, Soham Mansion, MG Road, Secunderabad.  
G S T No. : 36AAEFM1459R1ZP

**Supplier Details**

Linus Consultants Pvt.Ltd.  
Plot 38,Rd,#5,,Jubile Hills, Hyd - 500033.

**GSTIN** 36AAACL7034N1Z9 23550861  
23551855/23553929/23550781 7680022677/76

<b>Doc No</b>	95352	208547
<b>Doc Date</b>	23-12-2022	
<b>Quote No</b>	Nil	
<b>Quote Date</b>	23-12-2022	
<b>SupplyType</b>	Supply	

**Kind Attn : Mr. Srikant**

Purchase Order for the Supply of following Items.

Item Name	Qty	Rate	Dis%	GST	Amount
1 117200 - FUNF-Furniture & fixtures - Kitchen cabinets-Laminated MDF-Wenge - - - sqm Closed Cabinet Type-A2-SFT	51.00	1,000.00	0.00	18.00	60,180.00
<b>Total Order Value . . .</b>					<b>60,180.00</b>

Rupees : Sixty Thousand One Hundred Eighty Only.

**Terms and Conditions :-**

**Specification / Brand** As per approved drawing, design & quotation & ltr. of conf. dt.18/11/2016 shall be applicable. Closed cabinete rate per sft Rs.1000/-

**Payment Terms** 50% adv. shall be paid at the time of W.O., bal. amount shall be paid within 7days of delivery of material and raising of invoice.

**Tax** All taxes included in above price.

**Delivery Date** Within 15days.

**Delivery Location** Gulmohar Residency  
Survey No 19, Mallapur, Hyderabad. NExt to NFC Railway Over Bridge  
Phone. Contact: Security \_\_\_\_\_, 8309938133

**Penalty For Delay** Nil

**Transportation Cost** Included in above price

**Warranty** 1Yr from date of installation against any defects in manufacturing. Prompt & Regular service shall be given by you for repair.

**Advance Paid** Rs.30,090.00

**Other Terms** We reserve the right to reject items not conforming to quality and specifications. Above order for G-103 Modular kitchen work purpose.

**Completion Date** Installation of the Modular Kitchen at site shall be done at our cost.

**Measurement** You shall provide packing list along with delivery of material clearly specifying the items included.seperate pckng shall be made for each kitchen.

**Security** Nil

**Remarks** 'Original invoice + copy of proof of delivery is required to process invoice for payment. DO NOT send original invoice to site. Original invoices must be sent to HO office or purchase site office. Proof of delivery/DC can be sent by email.'

For **Modi Reality Mallapur LLP**

Authorised Signatory

Accepted the above Terms And Conditions

For **Linus Consultants Pvt.Ltd.**

Name : \_\_\_\_\_

Name : \_\_\_\_\_

Date : \_\_/\_\_/\_\_

# Estimate/Draft PO



95352

13.12.22 4:32:58

From Company : **Modi Reality Mallapur LLP**  
5-4-187/3&3, II nd floor, Soham Mansion, MG Road, Secunderat  
G S T No. : 36AAEFM1459R1ZP

## Supplier Details

Linus Consultants Pvt.Ltd.  
Plot 38,Rd,#5,,Jubile Hills, Hyd - 500033.

**GSTIN** 36AAACL7034N1Z9 23550861  
23551855/23553929/23550781 7680022677/76

<b>Doc No</b>	95352	208547
<b>Doc Date</b>	23-12-2022	
<b>Quote No</b>	Nil	
<b>Quote Date</b>	23-12-2022	
<b>SupplyType</b>	Supply	

## Kind Attn : Mr. Srikant

Estimate/Draft PO for the Supply of following Items.

Item Name	Qty	Rate	Dis%	GST	Amount
1 117200 - FUNF-Furniture & fixtures - Kitchen cabinets-Laminated MDF-Wenge - - - sqm Closed Cabinet Type-A2	4.50	10,764.00	0.00	18.00	57,156.84
<b>Total Order Value . . .</b>					<b>57,156.84</b>

Rupees : Fifty Seven Thousand One Hundred Fifty Six and Paise Eighty Four Only.

## Terms and Conditions :-

**Specification / Brand** As per approved drawing, design & quotation & ltr. of conf. dt.18/11/2016 shall be applicable. Closed cabinate rate per sft Rs.1000/-

**Payment Terms** 50% adv. shall be paid at the time of W.O., bal. amount shall be paid within 7days of delivery of material and raising of invoice.

**Tax** All taxes included in above price.

**Delivery Date** Within 15days.

**Delivery Location** Gulmohar Residency  
Survey No 19, Mallapur, Hyderabad. NExt to NFC Railway Over Bridge  
Phone. Contact: Security \_\_\_\_\_, 8309938133

**Penalty For Delay** Nil

**Transportation Cost** Included in above price

**Warranty** 1Yr from date of installation against any defects in manufacturing. Prompt & Regular service shall be given by you for repair.

**Advance Paid** Rs.28,578.00

**Other Terms** We reserve the right to reject items not conforming to quality and specifications. Above order for G-103 Modular kitchen work purpose.

**Completion Date** Installation of the Modular Kitchen at site shall be done at our cost.

**Measurment** You shall provide packing list along with delivery of material clearly specifying the items included.seperate pckng shall be made for each kitchen.

**Security** Nil

**Remarks** 'Original invoice + copy of proof of delivery is required to process invoice for payment. DO NOT send original invoice to site. Original invoices must be sent to HO office or purchase site office. Proof of delivery/DC can be sent by email.'

**For MDs APPROVAL**  
 High Value/quantity beyond limits.  
 Po/Req. processed-post approval.  
 Approval for technical details/clarification.  
 Replenishing SLLP stock  
 Other

**APPROVED BY**  
**23 DEC 2022**  
**SOHAM MODI**  
**MANAGING DIRECTOR**

For **Modi Reality Mallapur LLP**

Authorised Signatory

*Veeru*  
*23/12/22*

Accepted the above Terms And Conditions

For **Linus Consultants Pvt.Ltd.**

Name : \_\_\_\_\_

Name : \_\_\_\_\_

Date : \_\_\_/\_\_\_/\_\_\_

Requisition Form

Company Name: MRMLLP

Date: 29.12.2022

Site & Phase : GMR

Time: 1:00

Unit No./Block No. G-Block 103

Supplier:

208547

Material required before date:

Req. No.

ID No.

S No

Item

Qty required

Qty available at site

Order Qty

Inward No

Inward Date

1 FUNF6955-Furniture & fixtures-Kitchen cabinets-Laminated MDF-Wenge --Sqm

4.73

0

4.73

2

3

4

5

6

7

8

9

10

Remarks: Towards G-Block flat.no 103(A2-Type) Modular Kitchenwork purpose.

Engineer

G.Rajesh

Prepared By:

Approved By:

Sign & Date: 29.12.2022

Project Manager  
Ram Prasad

MD

**APPROVED**  
29 DEC 2023  
P.VENKATESHWARLU  
MANAGER PURCHASE

**ELEVATION- A**



APPROVED BY  
- 9 OCT 2020  
SOMAN M. C. DI  
MANAGING DIRECTOR

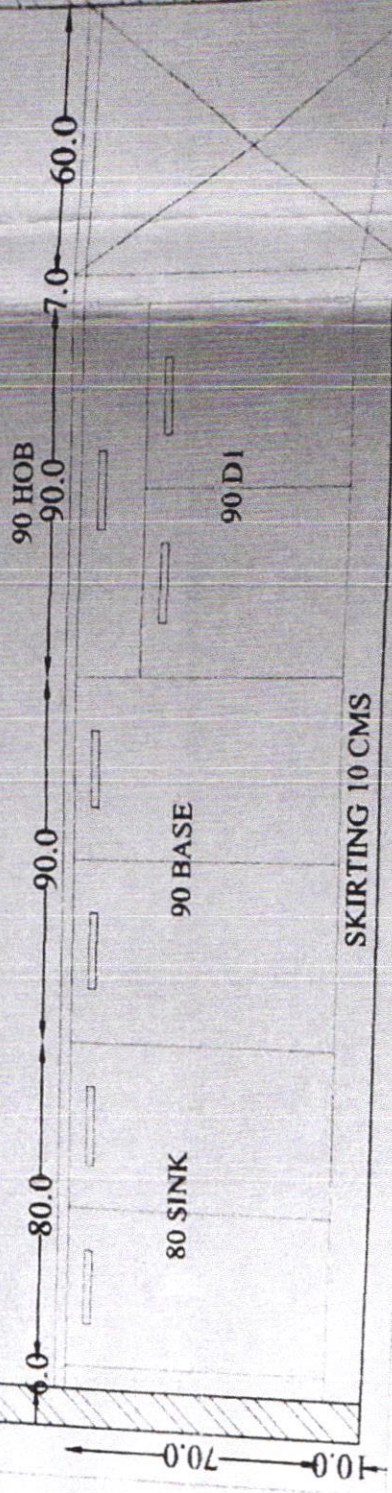
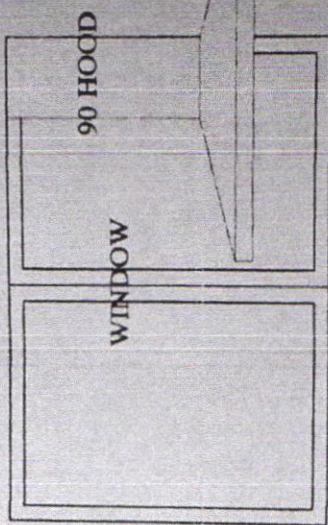
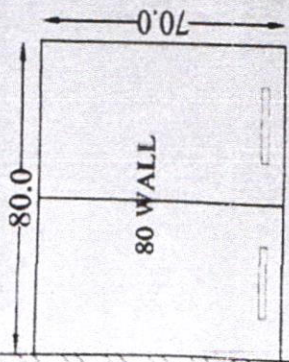

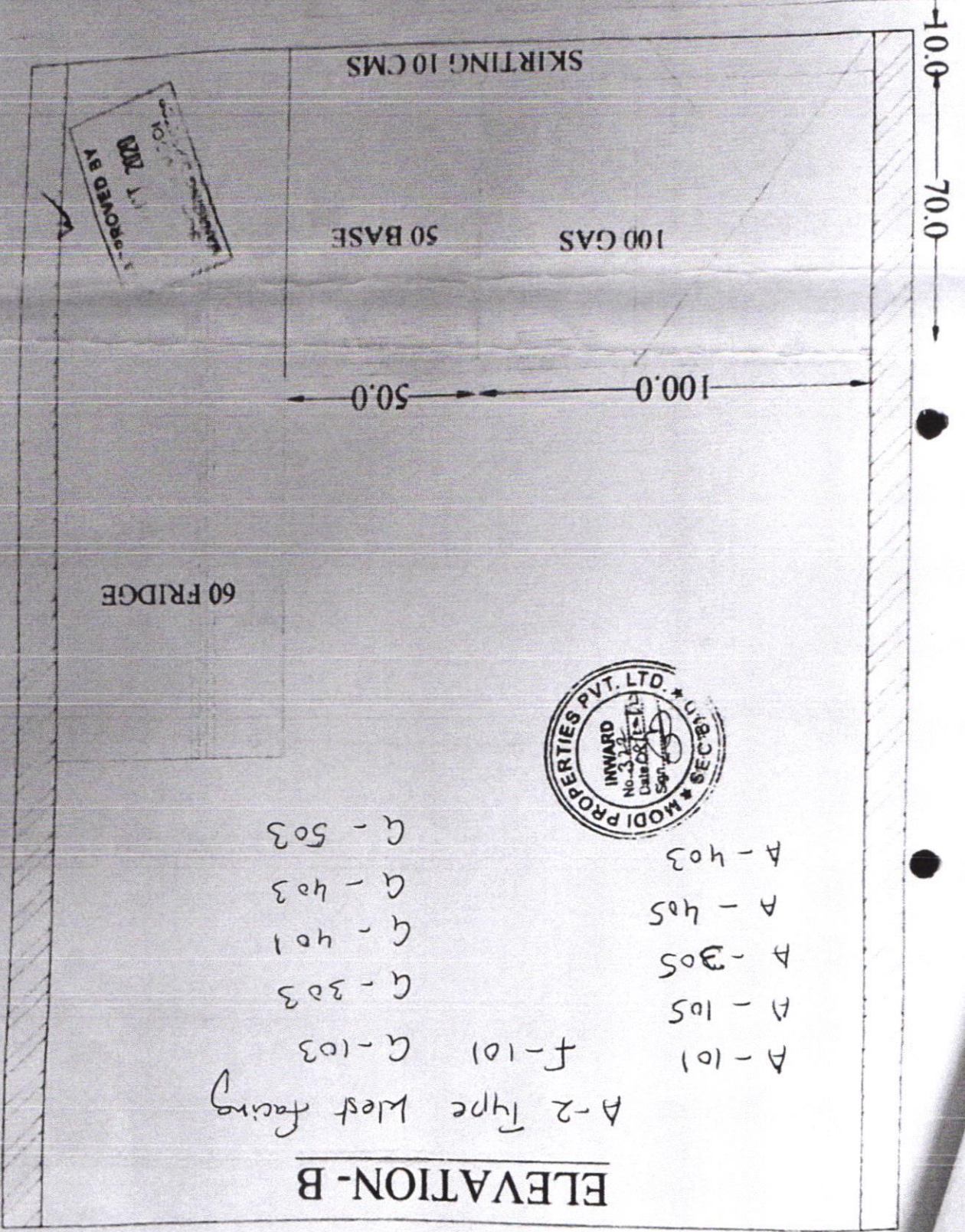





DNE created with pdfFactory Pro

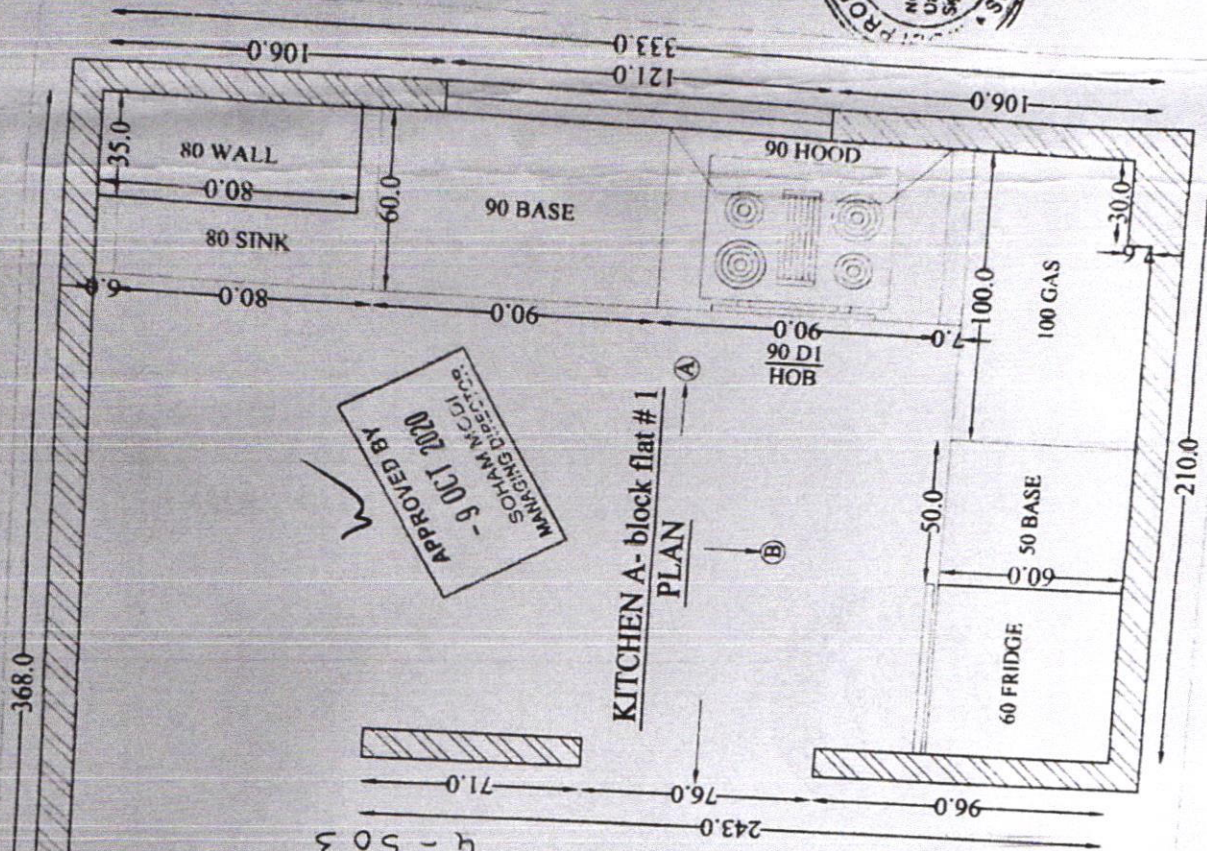

APPROVED BY  
- 9 OCT 2020  
SOHAM MCGILL  
MANAGING DIRECTOR

KITCHEN A-block flat #1  
PLAN

- A-101
- A-105
- A-305
- A-405
- A-403
- A-403
- A-503
- F-101
- G-103
- G-303
- G-401
- G-403
- G-503

A-2 Type West Facing

**LINUS CONSULTANT PVT LTD**Plot No 38, Road No 5, Jubilee Hills, Hyderabad. Email: accounts@kitchen-by-design.com  
GSTIN: 36AAACL7034N1Z9**DELIVERY CHALLAN**Party Name: **GULMOHAR RESIDENCY**Address: **SURVEY NO 19, MALLAPUR, HYDERABAD**DC No **JAN13-02**

FLAT NO G103

DC Date **13-01-2023**

TYPE 2

PO NO. 95352 / 23.12.2022

GST NO : **36AAEFM1459R1ZP**

State :

SL.NO	Description of Product	PKT	QTY
1	50 BASE		
2	90 BASE		1 SET
3	90 BASE D1		1 SET
4	80 PLY SINK		1 SET
5	80 WALL		1 SET
6	100 GAS PATTI		1 SET
7	498 X 700 SHUTTERS		1 SET
8	448 X 700 SHUTTERS		1 NO
9	898 X 173 DRAW FASCIAS		2 NOS
10	448 X 525 SHUTTERS		1 NO
11	398 X 700 SHUTTERS		2 NOS
12	100 X 700 FILLERS		2 NOS
13	100 X 150 GAS PATTIES		2 NOS
			3 NOS

Prepared By

Checked By

INWARD  
MODI REALTY MALLAPUR LLP  
Ward No 10679 DL 13/1/23  
MRN No 116276 DL 16/1/23  
Received By... Sign...

