



Site Office : Sy. No. 82/1, Mallapur Main Road,
Hyderabad- 500 076, ☎ : +91- 91213 10555
✉ : mpl@modiproperties.com
Developed by : Modi Properties Pvt. Ltd.



Head Office: 5-4-187/3&4, II Floor, M. G. Road,
Secunderabad - 500 003. ☎ +91 40 66335551,
✉ info@modiproperties.com www.modiproperties.com

Letter of Allotment for Car Parking

To,
Mr. Mallikarjuna Rao Chilukuri,
Flat no. A-801, Mayflower Platinum,
Mallapur, Hyderabad.

Date: 11.06.2025

Dear Madam / Sir,

Sub: Letter of allotment for Car Parking for the flat purchased by you in our project known as **Mayflower Platinum** forming part of Sy. No. 82/1, Mallapur village, Uppal Mandal, Medchal-Malkajgiri District.

You have purchased flat no. A-801 at **Mayflower Platinum** as per Sale Deed dated 01.09.2021, bearing document no. 5626/2021 registered at the office of the Sub-Registrar, Kapra, Medchal-Malkajgiri District. As per our agreement you have been allotted covered car parking of about 105 sft.

This letter is to confirm that you have been allotted car parking no. LBB-24 in the lower basement marked in red in the plan annexed.

You shall have absolute ownership rights on this car parking as per the terms and conditions of the above referred sale deed.

You shall not cover the car parking area by any permanent or temporary structure. You shall also abide by all the rules and regulations of Mayflower Platinum Welfare Association as applicable for this car parking allotted to you.

Thank you.

Yours Sincerely,

For Modi Properties Pvt. Ltd.

Soham Modi.
Authorised Signatory

Confirmed & Accepted

Signature:

Name: Mallikarjuna Rao Chilukuri

Date: 14/06/25

* Enclosed: Parking Plan

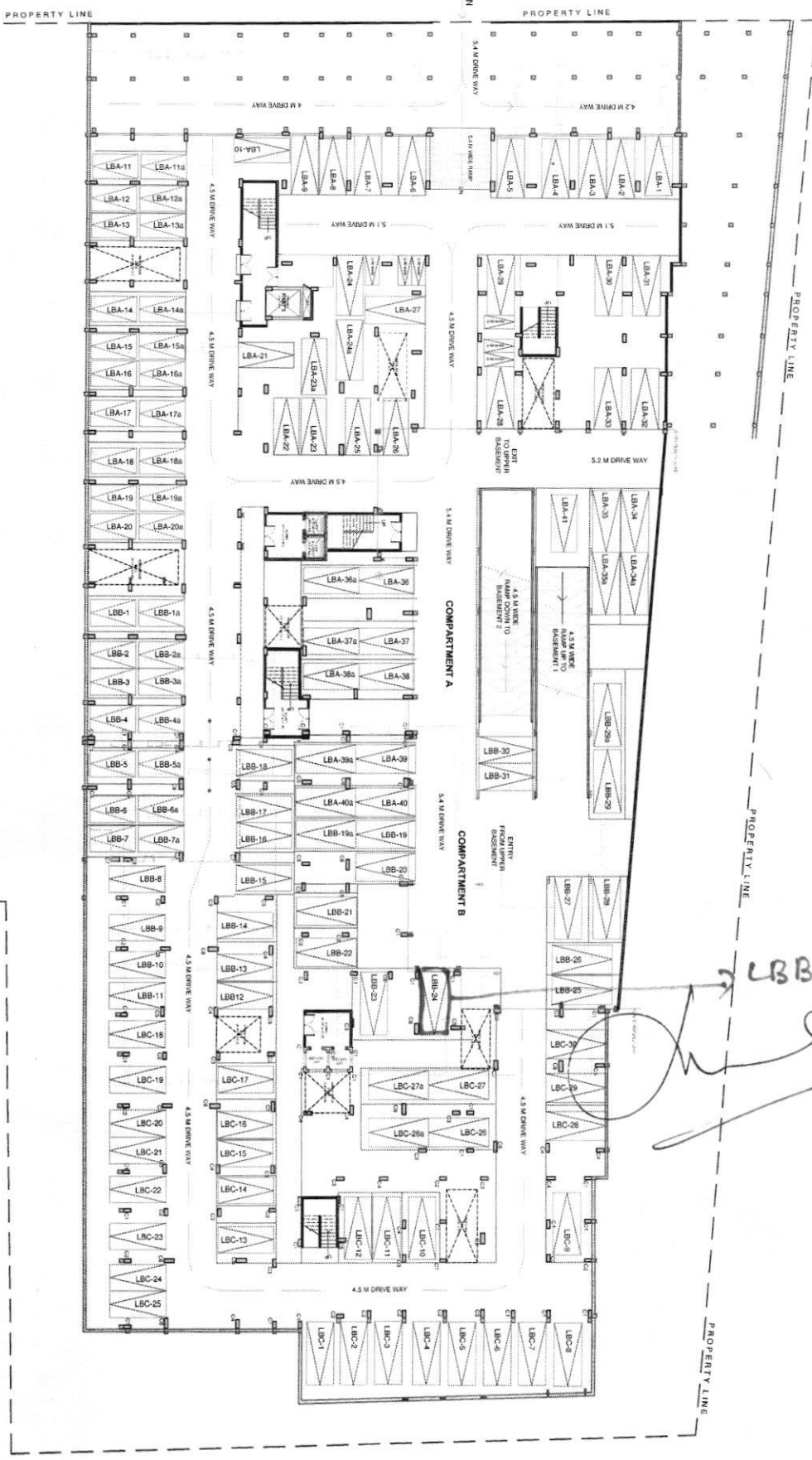

(L) BASEMENT CELLAR 2 -
No. of Car Parkings : 102

BLOCK	UPPER BASEMENT SINGLE	LOWER BASEMENT SINGLE	UPPER BASEMENT FAMILY	LOWER BASEMENT FAMILY	TOTAL
A	25	22	16	19	82
B	16	22	08	09	55
C	28	28	02	02	60
OTHER	12	-	-	-	12
TOTAL	81	72	26	30	209

PROJECT
MAYFLOWER PLATINUM
Highrise Apartments
MALLPUR
SECUNDERABAD
CLIENT
MODI PROPERTIES PVT.LTD

TITLE
ARCHITECTURAL DRAWING
PRESENTATION DRAWING

DRAWING DETAILS
MFP_Parking Layout- Basement-II

Scale: NTS
Drawn by: Manoj
Checked by: AR
Date: 24-01-23
Drawing Code: MP/WD/BM-2_P
Sheet No: 03
INTERIOR CONSULTANTS:

ARCHITECTS & INTERIOR DESIGNERS
7-1-2172, SHIVAJI, AMBERPET, HYDRABAD.
040-2375316, email: modidesign@gmail.com